

EDIE SCNCE

An exaggerated top column plays against the sconce's overall sense of quiet restraint. While Edie evokes a certain feeling of timelessness, it retains a fresh and modern presence.

Pictured in Vintage Brass with Opal Glass

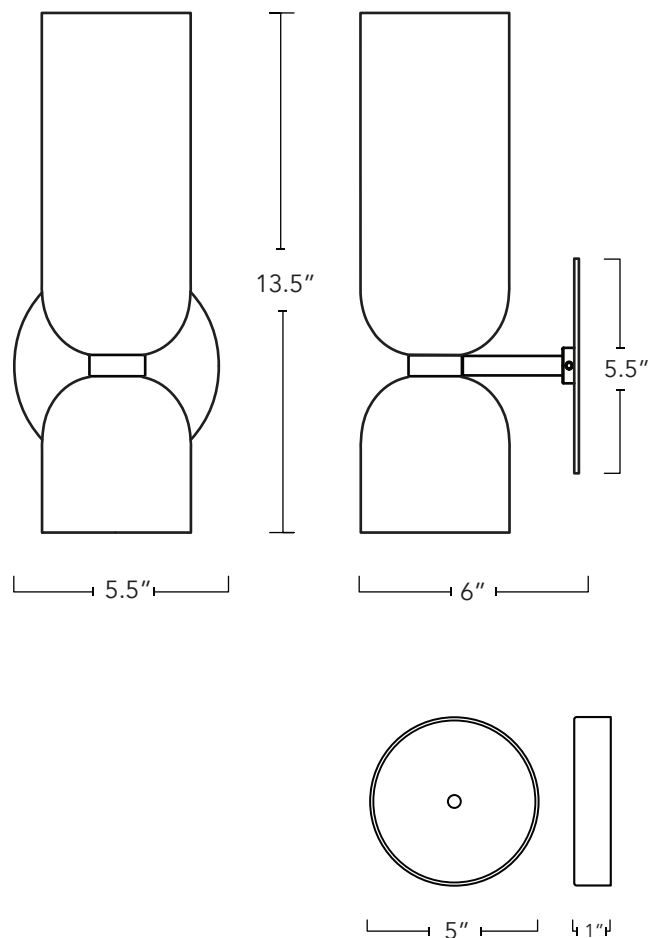

*Alternative 5" diameter,
1" deep back-plate available.

Type Wall Sconce

Dimensions Height: 13.5"
Width: 5.5"
Depth: 6"

Weight 3.5 lb / 1.6 kg

Materials & Finish Solid brass components with the exception of the polished nickel finish. Hand blown glass. Alternative 5" diameter deep-backplate available. Made by hand in Toronto, Canada.

Finishes: Vintage Brass
Blackened Brass
Polished Nickel
Glass Colors: Opal, Smoked Grey, Clear & Custom Colors

Illumination Voltage: 120V
Socket type: E12, Candelabra

Incandescent: G16.5 Globe in Gloss White
1 X 40W, 1 X 60W for a total of 100W
1 X 330, 1 X 580 lumens for a total of 910 lumens
2700K Color Temperature / Dimmable
or
Incandescent: G12 Globe in White
2 X 25W for a total of 50W
2 X 180 lumens for a total of 360 lumens
2700K Color Temperature / Dimmable
or
LED: G16 Globe in Milky White
2 X 4W for a total of 8W
2 X 350 lumens for a total of 700 lumens
2700K Color Temperature / Dimmable

Lead Time 4 to 8 Weeks

Certification cUL US