

PRESS RELEASE JULY 5, 2021

# Sanya Farm Lab



**Sanya Farm Lab is a 4000 sqm 4-storey exhibition space, located in Nanfan High Tech District of Sanya, the southernmost city on tropical Hainan Island. The design focus of the project is to combine the climate characteristics of Sanya, integrate the regional scientific and technological agricultural elements and create a multi-functional research compound and commercial display space.**

Sanya Farm Lab has been awarded Innovative Architecture 2020 by ICONIC Awards, and Excellent Architecture Special Mention in 2021 by German Design Awards.

**LANDMARK OF THE DISTRICT**



Nanfán District of Sanya is transforming into a tropical agriculture scientific research hub. The local government is investing in researches on environmental change, land/water scarcity and food production issues, as well as the growing demand of middle-class Chinese's desire to return to the natural field and rural area tourism.

The completion of the Nanshan Farm Lab is based on the modern organic agriculture display and the upgrading and evolution of lifestyles. It blurs the traditional boundaries between nature and the city and narrows the distance between technology and life.

## NOT JUST AN EXHIBITION CENTRE



The Farm Lab integrates and covering high-tech exhibitions such as agricultural robotics, indoor vertical farming, etc. It brings a brand new "farm-to-table" experience. The wish of



the design is to present the advanced technologies in front of the public in real-time, highlighting the progress which agricultural techs made in lifestyle and education territory. And its key point is to blur the boundaries between indoors and outdoors, maximising visitors' communication and interactions inside and outside the architectural building.



## PLATFORMS, STAIRS, AND SHADE



The architecture structure was developed into three steps: first, constructed outdoor public space. Set up an outdoor public space with clear scales and rich levels through

strategically combining four storeys' functional massing. The cantilever on the second floor created a semi-outdoor rain shelter for the first floor, and a relaxing outdoor public platform for outside dining and children's playing for the third floor.

Second, knitted outdoor public spaces together through outdoor circulation. Used a spiral stair and huge stairs of the multi-functional theatre to connect the indoor and outdoor, which made the flow more frequently to go outside and finally achieved the thorough connection.

Third, enhanced the comfort level of outdoor space. The 800MM deep roof grid structure reduced the sunlight absorption by 70%. It provided a shelter for the outdoor platform, and at the same time ensured natural ventilation and an open view. The grid structure inspired by the traditional house of Hainan Li nationality, which is a modern performance of the long-established architecture context.





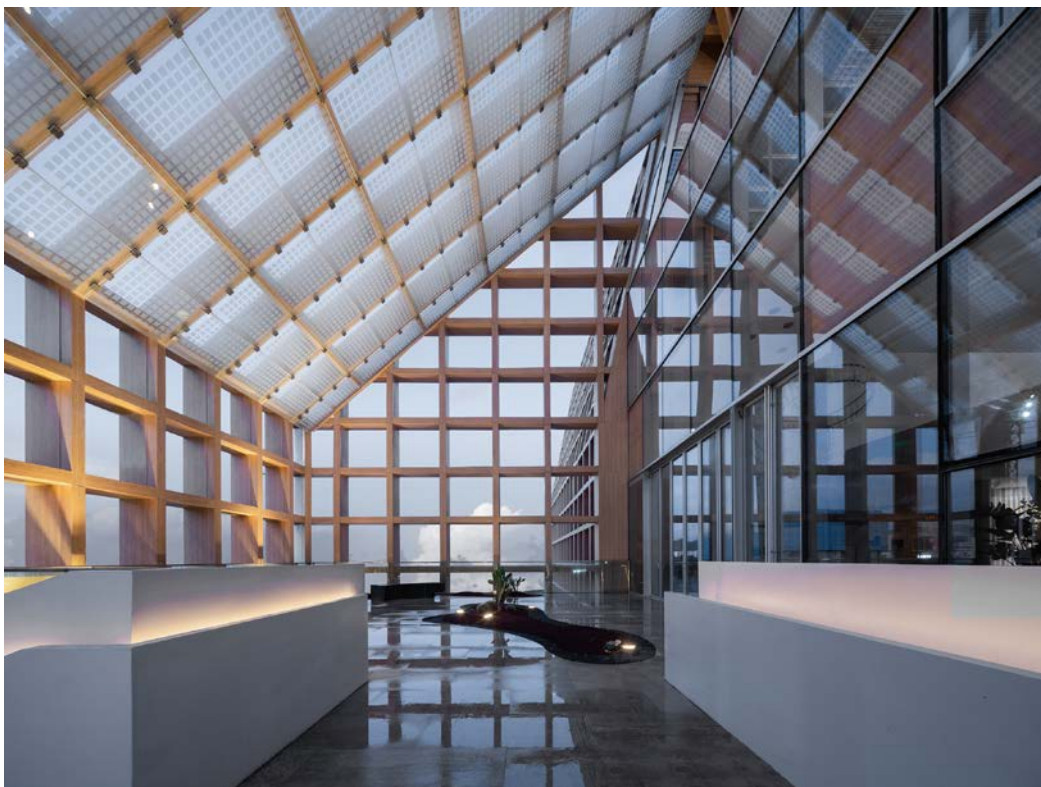

## PROJECT INFORMATION

Project Name: Sanya Farm Lab

Type: Exhibition, Retail

Client: Jinmao Sanya Nanfan Rongmao Real Estate Co., Ltd.

Location: Sanya, Hainan Island, China

Construction Area: 6,900 sqm

Status: Completion in 2021

Architecture Design: CLOU architects

Interior Design Concept: CLOU architects

Design Team Leader: Jan Clostermann, Lin Li

Design Team: Na Zhao, Sebastian Loaiza, Julien Douillet, Yaxi Wang, Tianshu Liu, Tiago Tavares,

Principia Wardhani, Javier Peláez, Yiqiao Zhao

Construction Drawings/MEP/Structure: Urban Architecture Design Co., Ltd

Façade Consultant: China Building Technique Group Co., Ltd.

Interior Design Construction Drawings: G-Aart design

Lighting Consultant: Fuzhou Bovs Lighting Design Co., Ltd.

Photography: Shining Laboratory

– ENDS –

## ON CLOU ARCHITECTS

**CLOU is an international design studio with award-winning expertise in architecture, interiors, and landscapes. The team designs their projects - many of them of a large scale - around community nodes and social spaces.**

A community of 65+ talents from China, and all over the world enjoy working collaboratively and imaginatively on bespoke projects. Their demanding clients range from shopping mall developers to house builders, hotel operators, and schools. In the process, CLOU architects strive to realize projects that will positively influence the people involved in its process, the environment, and the communities who live and work there.

## ABOUT JAN CLOSTERMANN

Jan Clostermann is the Principal of CLOU architects. He is an award-winning architect with 20 years of international experience. Jan began his architectural studies at the Technical University in Berlin and in 2001 received his AA Diploma with a scholarship from the Architectural Association in London. Before founding CLOU in 2015 Jan collaborated with a Stirling Prize winning practice where he had the opportunity to pursue a broad range of projects from studios in London, Rotterdam, Singapore and Shanghai.

In 2005 following the success of the Clarke Quay and Shanghai Cruise Terminal projects, Jan moved to Beijing to direct the team designing Raffles City Beijing. Since then he has conceptualised and delivered numerous high profile mixed-use and retail projects.



## CONTACT INFORMATION

Public Relations:	CLOU architects
Email:	media@clouarchitects.com
Telephone:	+86 10 8527 0095
Address:	Sanlitun SOHO Tower B Unit 801 8 Gongti North Road Chaoyang District Beijing 100027

## MEDIA CHANNELS

Website:	www.clouarchitects.com
Instagram/twitter:	@clouarchitects
WeChat:	CLOU architects (Scan QR Code)
Weibo:	CLOUarchitects

