

Orchid Pavilion for Casa Wabi by CCA Centro de Colaboración Arquitectónica, Bernardo Quinzaños

Ready for immediate release



© Photography by Rafael Gamo, courtesy CCA Centro de Colaboración Arquitectónica

The Orchid Pavilion, designed for Casa Wabi and inaugurated on February 3rd, 2024, is located on the outskirts of Puerto Escondido, between the sea and the mountains. It is a wooden structure, permanent, sustainable, and lightweight, dedicated to the conservation of orchids in the Oaxaca region, which highlights the strong relationship between the biological and cultural diversity of the landscape.

As we approached the design of the Orchid Pavilion at Casa Wabi, our research pointed toward some clear technical features, components, and facts. It became evident that in order to grow, reproduce, and collect orchids, we needed to create the right environment for them to thrive: humid, partially shaded, and well-ventilated

But more interestingly, the relationship between the Japanese philosophy of Wabi-Sabi, which believes that beauty and harmony are found in simplicity, imperfection, and unconventionality, and the rich and complex traditions of the Oaxacan coast—its vernacular, locally sourced materials, and the high quality of the artisanal works of the local craftsmen—were to be at the center of our proposal. Then, unexpectedly, we thought of the Japanese word *Ikigai*.

Ikigai (生き甲斐, 'a reason for being') could be roughly translated as the happiness of being busy. The term combines two Japanese words: *iki* (生き, meaning 'life or alive') and *kai* (甲斐, meaning 'an effect, result, fruit, or worth'), resulting in 'a reason for being alive'.

When somebody finds their purpose, their calling, they are more likely to lead a long, healthy life. However, it's easy to get lost in the stress and noise of our daily routine, so we need to make space, we need to chill out, in this case, with the orchids.

When you enter the pavilion, you breathe in the humidity, hear the gentle drops falling, feel the crossing winds, and hopefully, you will be able to remember who you are, what your reason for being is. What is your *Ikigai*.



© Photography by Rafael Gamo,
courtesy CCA Centro de Colaboración Arquitectónica



© Photography by Jaime Navarro, courtesy CCA Centro de Colaboración Arquitectónica

Our pavilion focuses on three main elements:

Firstly, the pavilion is a simple and austere machine. Twelve concrete-based humidifiers utilize gravity to create a humid environment within the structure that houses orchids from the Oaxacan coast.

Secondly, the pavilion employs simple construction materials and techniques, including locally sourced wood and custom-made concrete ceramic pieces baked in high-temperature kilns.

And thirdly, the pavilion serves as a sanctuary for the orchids while also aiming to evoke a profound sense of Ikigai in its visitors.

The main element that allows orchids to thrive is a humid environment. The intricate roots, branches, and leaflets gather water from the air, soil, and all surfaces. A series of pyramid-shaped, water-filled concrete basins rests at the top of a simple wooden structure. The basins slowly filter tiny droplets of water that fall to the ground, allowing for drip irrigation. The water is collected by concrete-based trays that remain permanently humid. The breeze and heat enable the orchids to drink water directly from the environment, eliminating the need for manual watering of the specimens.

"Life is the essence of wetness, and wetness is the essence of beauty" - Derek Zoolander

To the guests of Casa Wabi, the orchid pavilion offers a refuge to sit and drink water after a long walk. Remembering that the first steps of humanity occurred in the shade of a tree, the pavilion also communicates a contemplative journey, as the water people drink is the same water orchids drink.

The sound of dripping in the bowls resonates with different natural cycles and human activity. This cool, semi-submerged space changes the horizon and perspective of visitors as they descend to ground level, allowing them not only to appreciate the diversity of orchid species but also to connect with the humble root of life in a state of harmony.

DATA SHEET



Nombre / Name	Orchid Pavilion / Pabellón de las Orquídeas
Uso / Use	Cultural
Área / Area	40.45m ²
Ubicación / Location	Puerto Escondido, Oaxaca
Estado / Status	Construido
Año / Year	2023
Oficina / Office	CCA Centro de Colaboración Arquitectónica Bernardo Quinzaños
Arquitecto / Architects	Bernardo Quinzaños
Equipo / Team	Begoña Manzano, Andrés Suárez, Miguel Izaguirre, Florencio de Diego, Carlos Cruz Ay, Javier Castillo, Carlos Molina, Fernanda Ventura
Cliente / Client	Fundación Casa Wabi
Fotografía de Maqueta / Model Photography	Vanessa Nieves, Arturo Arrieta, CCA Centro de Colaboración Arquitectónica
Fotógrafo / Photographer	Jaime Navarro, Rafael Gamo
Contacto Medios / Media Contact	Fernanda Ventura fernanda@cca.mx

CONTACT SHEET

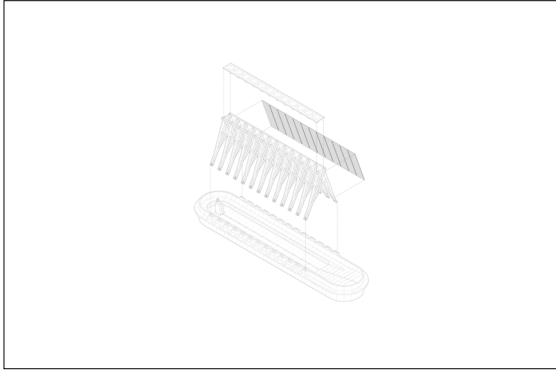

01 Diagrama Explotado_Orchid Pavilion_CCA. JPG & PDF
Image Description: Exploded Diagram
Image Credit: ©Drawing by CCA Centro de Colaboración Arquitectónica

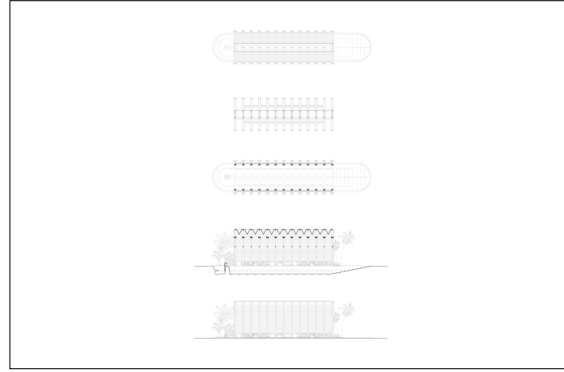

02 Montea_Orchid Pavilion_CCA. JPG & PDF
Image Description: Drawing
Image Credit: ©Drawing by CCA Centro de Colaboración Arquitectónica

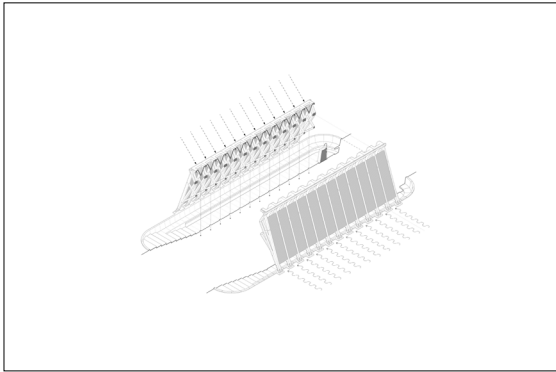

03 Diagrama de funcionamiento_Orchid Pavilion_CCA. JPG & PDF
Image: Functional Diagram
Image Credit: ©Drawing by CCA Centro de Colaboración Arquitectónica

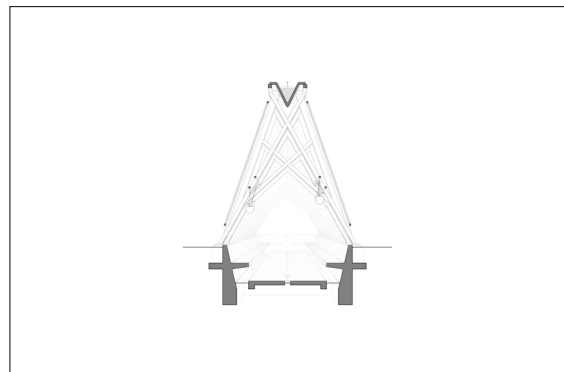

04 Corte Fugado_Orchid Pavilion_CCA. JPG & PDF
Image Description: Section
Image Credit: ©Drawing by CCA Centro de Colaboración Arquitectónica

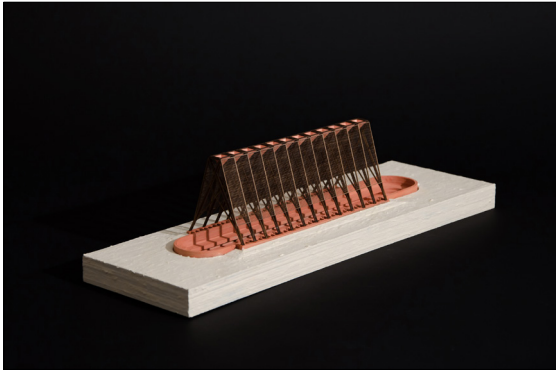

01 Maqueta Concurso_Orchid Pavilion_Foto CCA. JPG & TIFF
Image Description: Photography model
Image Credit: ©Photography by CCA Centro de Colaboración Arquitectónica

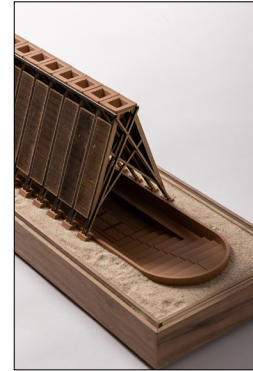

02 Maqueta Final_Orchid Pavilion_Foto Arturo Arrieta. JPG & TIFF
Image Description: Photography model
Image Credit: ©Photography by Arturo Arrieta, courtesy of CCA Centro de Colaboración Arquitectónica



03 Maqueta Final_Orchid Pavilion_CCA. JPG & TIFF
Image Description: Photography model
Image Credit: ©Photography by Vanessa Nieves, courtesy of CCA Centro de Colaboración Arquitectónica

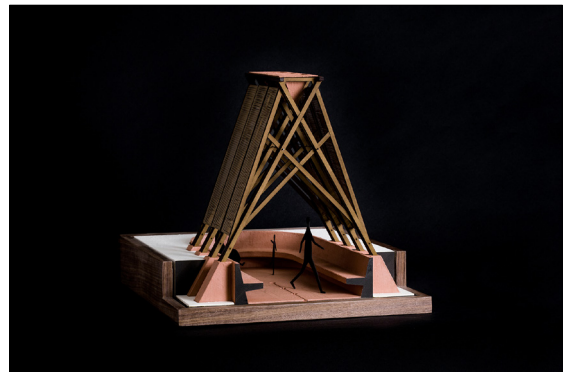

04 Maqueta Final_Orchid Pavilion_CCA. JPG & TIFF
Image Description: Photography model
Image Credit: ©Photography by CCA Centro de Colaboración Arquitectónica

CONTACT SHEET



00 Orchid Pavilion_CCA_Foto Jaime Navarro. JPG & TIFF
Image Description: Photography
Image Credit: ©Photography Jaime Navarro courtesy of CCA Centro de Colaboración Arquitectónica



01 Orchid Pavilion_CCA_Foto Jaime Navarro. JPG & TIFF
Image Description: Photography
Image Credit: ©Photography Jaime Navarro courtesy of CCA Centro de Colaboración Arquitectónica



02 Orchid Pavilion_CCA_Foto Jaime Navarro. JPG & TIFF
Image Description: Photography
Image Credit: ©Photography Jaime Navarro courtesy of CCA Centro de Colaboración Arquitectónica



03 Orchid Pavilion_CCA_Foto Rafael Gamo. JPG & TIFF
Image Description: Photography
Image Credit: ©Photography Rafel Gamo courtesy of CCA Centro de Colaboración Arquitectónica



04 Orchid Pavilion_CCA_Foto Rafael Gamo. JPG & TIFF
Image Description: Photography
Image Credit: ©Photography Rafel Gamo courtesy of CCA Centro de Colaboración Arquitectónica

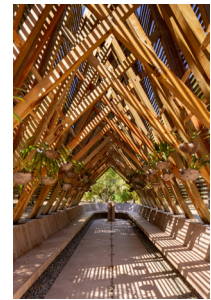

05 Orchid Pavilion_CCA_Foto Rafael Gamo. JPG & TIFF
Image Description: Photography
Image Credit: ©Photography Rafel Gamo courtesy of CCA Centro de Colaboración Arquitectónica



06 Orchid Pavilion_CCA_Foto Rafael Gamo. JPG & TIFF
Image Description: Photography
Image Credit: ©Photography Rafel Gamo courtesy of CCA Centro de Colaboración Arquitectónica

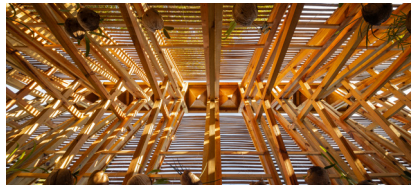

07 Orchid Pavilion_CCA_Foto Rafael Gamo. JPG & TIFF
Image Description: Photography
Image Credit: ©Photography Rafel Gamo courtesy of CCA Centro de Colaboración Arquitectónica

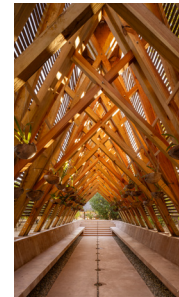

08 Orchid Pavilion_CCA_Foto Rafael Gamo. JPG & TIFF
Image Description: Photography
Image Credit: ©Photography Rafel Gamo courtesy of CCA Centro de Colaboración Arquitectónica



09 Orchid Pavilion_CCA_Foto Jaime Navarro. JPG & TIFF
Image Description: Photography
Image Credit: ©Photography Jaime Navarro courtesy of CCA Centro de Colaboración Arquitectónica



10 Orchid Pavilion_CCA_Foto Rafael Gamo. JPG & TIFF
Image Description: Photography
Image Credit: ©Photography Rafel Gamo courtesy of CCA Centro de Colaboración Arquitectónica



11 Orchid Pavilion_CCA_Foto Rafael Gamo. JPG & TIFF
Image Description: Photography
Image Credit: ©Photography Rafel Gamo courtesy of CCA Centro de Colaboración Arquitectónica

CONTACT SHEET



12 Orchid Pavilion_CCA_Foto Jaime Navarro. JPG & TIFF
Image Description: Photography
Image Credit: ©Photography Jaime Navarro courtesy of CCA Centro de Colaboración Arquitectónica



13 Orchid Pavilion_CCA_Foto Jaime Navarro. JPG & TIFF
Image Description: Photography
Image Credit: ©Photography Jaime Navarro courtesy of CCA Centro de Colaboración Arquitectónica



14 Orchid Pavilion_CCA_Foto Rafael Gamo. JPG & TIFF
Image Description: Photography
Image Credit: ©Photography Rafel Gamo courtesy of CCA Centro de Colaboración Arquitectónica



15 Orchid Pavilion_CCA_Foto Rafael Gamo. JPG & TIFF
Image Description: Photography
Image Credit: ©Photography Rafel Gamo courtesy of CCA Centro de Colaboración Arquitectónica



16 Orchid Pavilion_CCA_Foto Jaime Navarro. JPG & TIFF
Image Description: Photography
Image Credit: ©Photography Jaime Navarro courtesy of CCA Centro de Colaboración Arquitectónica

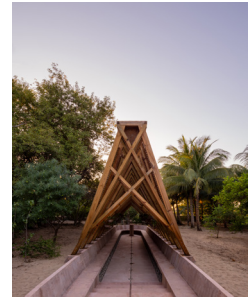

17 Orchid Pavilion_CCA_Foto Rafael Gamo. JPG & TIFF
Image Description: Photography
Image Credit: ©Photography Rafel Gamo courtesy of CCA Centro de Colaboración Arquitectónica

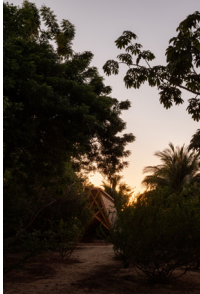

18 Orchid Pavilion_CCA_Foto Rafael Gamo. JPG & TIFF
Image Description: Photography
Image Credit: ©Photography Rafel Gamo courtesy of CCA Centro de Colaboración Arquitectónica

CCA | Centro de Colaboración Arquitectónica

© 2024 CCA Centro de Colaboración Arquitectónica

All rights reserved. The contents of this document are confidential and for internal use only, and may not be published, distributed, or otherwise broadcasted without the express written consent of the copyright holder.