

A20

LIME TREE VALLEY A20

JUMEIRAH GOLF ESTATES

By

G R O U N D E D E S T A T E S



— A20 —



The Pinnacle of Elegance and Comfort

Villa A20

Lime Tree Valley, Jumeirah Golf Estates

Imagine your own sanctuary brimming with luxury and natural beauty. Nestled within Jumeirah Golf Estates, this exquisite villa is surrounded by pristine landscapes and the serene ambiance of Dubai's premier private golf course community.

Every aspect of this home is designed for ultimate indulgence, allowing you to enjoy life's finest pleasures whenever you desire. Here, every detail is meticulously attended to, creating a haven where stress simply melts away. Welcome to a new standard of elegance and comfort with Grounded Estates.

Lime Tree Valley

Jumeirah Golf Estates

Villa A20

Project Scale: GF + FF

Plot Area. 9,652 Sq.Ft. 897 Sq.M

Built-Up Area. 6,606 Sq.Ft. 614 Sq. M

Featuring

5 Bedrooms

Office

Wine Cellar

Sunken Seating with Fire-pit in Pool

First Floor Family Lounge

Show Kitchen & Back Kitchen

Maids & Drivers rooms



Designed By: Grounded Design

Ground Floor

Lime Tree Valley

Jumeirah Golf Estates

Villa A20

Project Scale: GF + FF

Plot Area. 9,652 Sq.Ft. 897 Sq.M

Built-Up Area. 6,606 Sq.Ft. 614 Sq. M

Designed By: Grounded Design



First Floor



Your Personal Oasis of Calm and Tranquility

— A20 —

One of a Kind

A Signature Villa

Designed To Impress

Welcome to a masterpiece of luxury and sophistication, nestled within the prestigious Jumeirah Golf Estates. This stunning villa is a sanctuary of elegance, offering an unparalleled living experience in one of Dubai's most sought-after communities.

Every detail of this home has been meticulously designed to provide the utmost in comfort and style, from its grand double-height entrance to its state-of-the-art home automation system. Here, you'll find the perfect blend of opulence and functionality, creating a haven where you can indulge in the finest aspects of life.

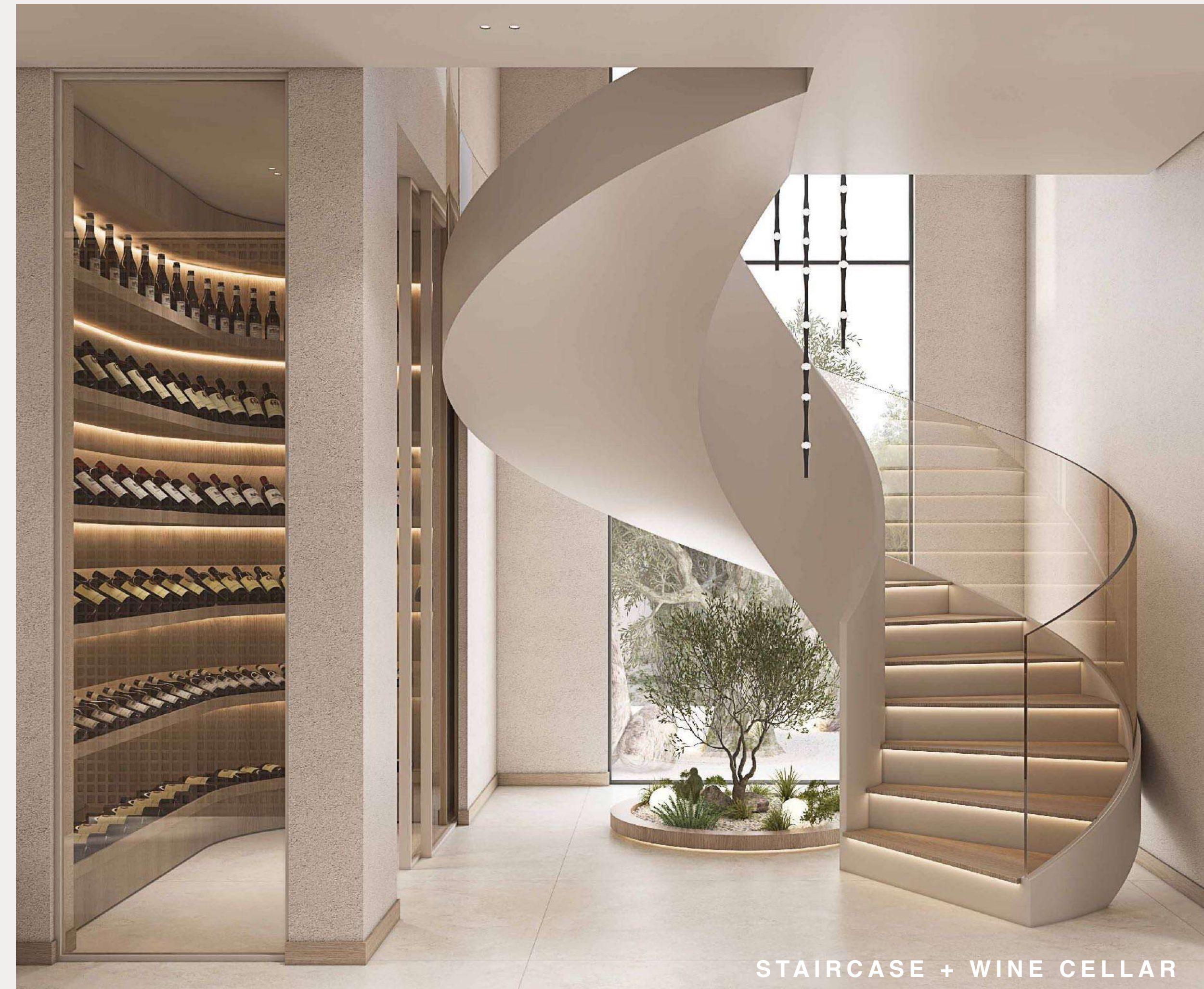

STAIRCASE + WINE CELLAR



FORMAL LOUNGE AREA



WALK-IN CLOSET

Luxurious Living Redefined

Spacious Bedrooms With En-Suite Elegance

Imagine a residence where every detail exudes luxury and comfort. This villa features five generously sized bedrooms, each with its own en-suite bathroom, ensuring ultimate privacy and convenience for all residents.



MASTER BATHROOM



Luxurious and Elegant

Spa-Like En-Suite Bathrooms

Premium Fixtures and Finishes

Each bathroom in the villa is designed to provide a spa-like experience, featuring high-end fixtures and finishes. Premium materials and top-of-the-line sanitary ware ensure both elegance and functionality, creating a serene retreat within your home.



Grand Entrance, Welcoming Ambiance

Double-Height Foyer

Filled with Natural Light

As you step through the grand double-height entrance, you are greeted by a magnificent and airy foyer that immediately conveys a sense of welcoming grandeur. The expansive space, filled with natural light, sets the tone for the rest of the home, promising a luxurious and inviting atmosphere throughout.







A Haven for Work and Relaxation

Family Lounge for Leisure and Bonding Office with Optimal Functionality

The villa includes a first-floor family lounge providing a spacious and comfortable area for relaxation and family bonding.

Additionally, the meticulously designed home office offers an ideal environment for productivity and focus, ensuring perfect spaces for both work and leisure.



Harmonious Culinary and Utility Spaces

Top-Notch Show Kitchen

Functional Back Kitchen and Ample Pantry Space

The show kitchen is outfitted with premium Gaggenau appliances, ensuring an exceptional culinary experience for even the most discerning chefs.

Additionally, the back kitchen and pantry are designed to provide ample storage and preparation space, catering to every culinary need. The villa also features spacious maids' and drivers' rooms, ensuring that all household requirements are efficiently met.



KITCHEN



DINING AREA



Seamless Integration of Luxury and Technology

Advanced Home Automation System Built-In Speakers for Enhanced Living

The home automation system and built-in speakers seamlessly enhance your lifestyle.

While high-end finishes and materials, including Italian tiles, Swedish hardwood flooring, and premium sanitary ware, add an extra touch of elegance throughout the villa.



MASTER BEDROOM



MASTER BATHROOM



MASTER BATHROOM



Nature-Inspired Interior Design

The warm and inviting interior
featuring earthy finishes inspired by nature

Using wood and stone as the foundation for the entire villa, a smart layout incorporates every aspect of comfort with practical design solutions, ensuring a seamless living experience.



Your Dream Home

— A20 —



A Sanctuary of Comfort and Serenity

Elegant Outdoor Living

Serene Poolside Retreat

Experience the epitome of luxurious outdoor living with this serene villa setting. The elegant design seamlessly integrates indoor and outdoor spaces, featuring expansive high-quality windows that flood the interior with natural light and provide unobstructed views of the lush surroundings.

The inviting pool area, surrounded by lush greenery and stylish seating, offers a perfect retreat for relaxation and entertaining. The harmonious blend of modern architecture and natural elements creates a tranquil oasis where you can unwind and enjoy the beauty of your surroundings.

Spectacular Golf Course Views*



Idyllic Setting

Unparalleled Serenity

Experience breathtaking views from your villa, overlooking the pristine Jumeirah Golf Estates Golf Club. This idyllic setting offers a serene and picturesque landscape, where lush greens meet tranquil waters. The panoramic vistas create a perfect backdrop for luxurious living, blending the beauty of nature with the elegance of the golf course. Enjoy the unparalleled serenity and charm that this exclusive location provides, making every moment at home a true retreat.

*Actual view from villa



Grand Arrival

Stunning Entrance

Sophisticated Aesthetic

The entrance of this villa exudes sophistication and elegance. A grand doorway welcomes you, setting the tone for the luxury that lies within. The clean lines and high-quality materials, including sleek wood and expansive windows, create an inviting and modern aesthetic. This meticulously designed entrance ensures a striking first impression, combining both beauty and functionality to elevate the overall ambiance of the villa.





A Haven of Relaxation and Beauty

Escape the city's hustle and bustle at this exclusive villa in Jumeirah Golf Estates. This unique residential development offers a tranquil oasis amidst Dubai's vibrant landscape.

Indulge in a serene lifestyle where luxurious design meets captivating natural surroundings. Immerse yourself in lush greenery and pristine golf courses. Find your personal retreat in this prestigious community, where luxury and tranquility seamlessly blend.



A place to choose your space,
your pace, and how you live your days

— A20 —

Jumeirah Golf Estates

World-Class Leisure and Luxury Living

Jumeirah Golf Estates stands as the world's premier destination for both leisure and residential living. Featuring world-class amenities and championship golf courses, this community offers a unique blend of luxury and tranquility.

Experience a lifestyle where every day is filled with unparalleled comfort, sophistication, and a vibrant community spirit.



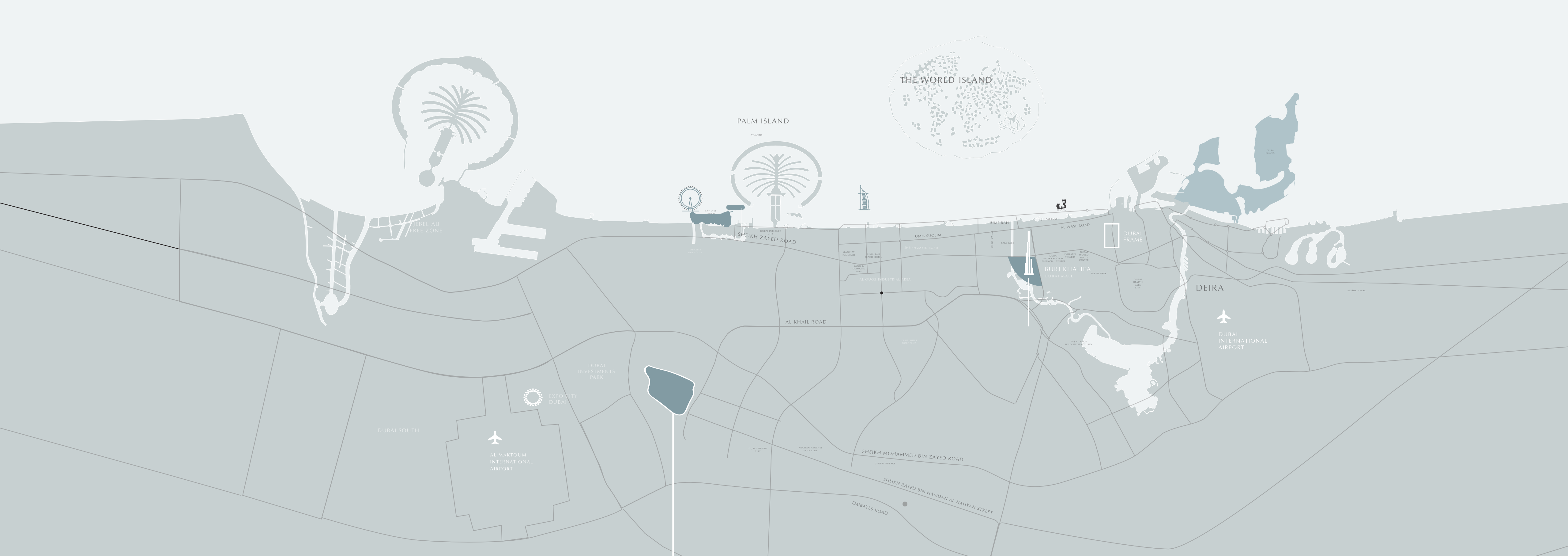

Jumeirah Golf Estates

25 Min

to Al Maktoum International Airport

10 Min

to Dubai Hills Estate
Dubai Hills Mall

15 Min

to Dubai Marina and
Dubai Marina Mall

20 Min

to Downtown Dubai
and Dubai Mall

Your Personal Oasis in a Vibrant City



TEE OFF IN CHAMPIONSHIP STYLE

Designed by the legendary Greg Norman, the world-renowned Fire and Earth championship golf courses provide a challenging and exhilarating playing experience.



Where the
world's best
come together

World Tour Championship

Golf Course



The 18-hole Earth course at Jumeirah Golf Estates hosts the DP World Tour Championship, where 60 of the world's best golfers compete in the thrilling Race to Dubai season finale.

This prestigious location is also home to one of only two European Tour Performance Institutes (ETPI) globally. Golfers of all ages can refine their skills or learn the basics at this award-winning facility, making it a premier destination for golf enthusiasts.



LIME TREE VALLEY

Experience the perfect blend of luxury and tranquility in The Lime Tree Valley. Nestled amidst lush greenery with breathtaking views of championship golf courses, every day here brings comfort, sophistication, and vibrant community living.



About Grounded Design

At Grounded Design, we are committed to creating properties with timeless and beautiful designs, complemented by high-quality, durable finishes. Through smart space planning that considers every aspect of effortless living,

We create homes you can be proud of. By combining our expertise in property development with Grounded Design's creativity, we strive to produce properties that are not only visually appealing but also perfectly balanced in functionality and tranquility.



LIME TREE VALLEY A20

For more information please call +971 (0) 52 461 4447

Or email us at: info@groundedestates.ae

GROUNDIED ESTATES