

**(Communication embargo until 18 June 2026)**



**VELLO BIKE**

## **VELLO INTRODUCES THE WORLD'S FIRST FOLDING E-BIKE FEATURING THE NEW BOSCH HUBLINE DRIVE SYSTEM**

Vienna, 18 June 2026. The new VIA+ range of electric folding bikes from VELLO sets a new benchmark in its class. Among the most compact and lightweight e-folding bikes on the market, it combines the performance of a powerful e-bike with the versatility and convenience of a folding bike. Thanks to the new Bosch HubLine motor and specially developed intelligent sensor technology – including an integrated incline sensor – the VIA+ delivers an exceptionally smooth, natural riding experience. At the same time, energy is used with remarkable efficiency, enabling impressive range even with a compact battery.

With the new VIA+ family, VELLO integrates the Bosch HubLine drive system into a premium electric folding bike for the first time, offering outstanding value for money. High-quality features include an integrated Supernova lighting system compliant with German StVZO regulations and hydraulic Shimano disc brakes. The result is an exceptionally lightweight, fully equipped e-bike designed for commuters, travellers, and urban explorers.

The patented VELLO diamond frame, which eliminates the need for a folding hinge in the main frame, gives the VIA+ a stable, direct, and dynamic ride feel. At the same time, it folds down in seconds for compact storage and easy transport.

The frame is made from double-buttressed Columbus CroMo steel tubing. As the world's only MTB-certified folding bike, the VIA+ is built not only for everyday urban mobility but also for weekend adventures and light off-road touring.

### **HIGHLIGHTS**

- Bosch HubLine motor with up to 45 Nm of torque and 400 W peak power
- Bosch eBike Flow App with navigation, theft protection, and incline-sensor support
- Removable battery with optional second battery (up to 500 Wh total capacity)
- USB-C smartphone charging
- Patented VELLO diamond frame without a folding hinge in the main frame (folds in seconds)
- Weight from 16.5 kg (36.4 lbs)
- Designed in Austria. Made in Europe.

**TEST RIDE THE NEW VIA+ AT EUROBIKE – OUTDOOR AREA F12 B40, JUNE 24-27, 2026.**



## TWO MODELS. ONE CONCEPT.

Introductory price from €2,990

### VIA+ TOUR

For riders seeking maximum versatility and sporty performance.

- Shimano Deore 10-speed drivetrain
- Hydraulic disc brakes
- Direct and precise shifting
- Ideal for commuting, touring, and demanding routes
- Weight from 16.5 kg (36.4 lbs)

### VIA+ URBAN

For riders looking for the lowest possible maintenance.

- Gates Carbon Drive belt system
- UTgear 2-speed internal gear hub
- Quiet and clean drivetrain
- Minimal maintenance requirements
- Perfect for everyday urban mobility
- Weight from 16.9 kg (37.3 lbs)

### ABOUT BOSCH HUBLINE

The new Bosch HubLine drive system provides up to 45 Nm of torque. Thanks to its integrated incline sensor, motor support automatically adapts to the riding situation and gradient. The Bosch eBike Flow App offers navigation, ride data, range management, and digital security features such as eBike Lock and location tracking.

The removable battery can be conveniently charged at home or in the office. For maximum range, total battery capacity can be increased to up to 500 Wh with an optional second battery.

### ABOUT VELLO

VELLO is a Vienna-based manufacturer of innovative bicycles for urban mobility. The company combines minimalist design with technical functionality, creating products that are built for durability, everyday usability, and seamless integration into urban environments. VELLO has received numerous international awards, including the Red Dot Award "Best of the Best", the Austrian National Design Award, the German Ecodesign Award, the German Design Award, the EUROBIKE Award 2025, and the iF Design Award 2026 for its VELLO SUB e-cargo bike.





VELLO BIKE

# THE WORLD'S FIRST FOLDING E-BIKE WITH BOSCH HUBLINE TECHNICAL SPECIFICATIONS – VELLO VIA+



**ePowered**

## POWERFUL, SAFE, AND FULLY EQUIPPED WITH AN INTEGRATED SUPERNOVA LIGHTING SYSTEM

The new VELLO folding e-bike with the new Bosch HubLine hub motor can be folded in just a few simple steps, making it easy to transport and store in compact spaces.

Starting at just 16.5 kg, the VELLO folding e-bike combines VELLO's proven ultralight frame concept with Bosch's reliable drive technology, making it one of the lightest 20-inch folding e-bikes on the market.

## NEW BOSCH DRIVE SYSTEM WITH UP TO 45 Nm OF TORQUE AND 400 W OF POWER

With up to 45 Nm of torque and 400 watts of peak power, the powerful rear hub motor delivers smooth, responsive support when it matters most. Its integrated inclination sensor automatically adapts assistance to the gradient and riding situation, making even demanding climbs feel more manageable. Combined with the compact 250 Wh battery, it offers reliable performance for everyday rides and beyond. The new Bosch LED controller with integrated USB charging ensures your smartphone stays powered wherever the ride takes you.



# UTgear

## MAXIMUM RIDING DYNAMICS 10-SPEED SHIMANO DEORE OR UTGEAR 2-SPEED INTERNAL GEAR HUB

The versatile folding e-bike is available with either a chain or belt drive.

The sporty 10-speed Shimano derailleur drivetrain offers fast, precise shifting for a dynamic and responsive ride. For those seeking a quieter, low-maintenance option, the Gates Carbon Drive belt version is paired with an innovative UTgear 2-speed hub gear, ideal for both city rides and touring. Its perfectly tuned 40% gear range supports a natural cadence up to 25 km/h while reducing unnecessary gear changes in urban traffic, creating an exceptionally smooth and comfortable riding experience.

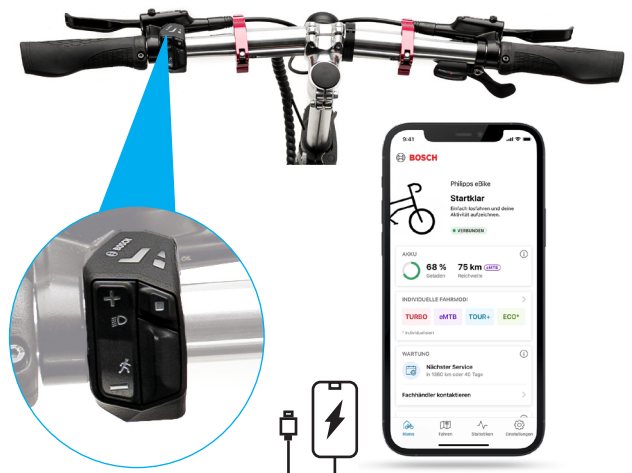

## SMART E-BIKE WITH APP CONNECTIVITY, INTELLIGENT REMOTE CONTROL, AND INCLINE SENSOR TECHNOLOGY

The new Bosch HubLine is making its debut on a folding bike with this new model from VELLO. It connects with the eBike Flow app via smartphone, through which riders can fully customise their bike, from adjusting support levels to analysing ride data and range, planning routes, and navigation. Smart safety features, including digital theft protection, precise location tracking and automatic movement alerts, offer peace of mind in every situation.



## MODULAR BATTERY SYSTEM WITH UP TO 500 Wh CAPACITY

The electric folding bike is equipped with a practical removable battery that can be conveniently charged at home or in the office. A single battery charge provides a range of up to 62 km (39 miles). For longer journeys, the frame features an additional mounting point for a second battery, allowing total capacity to be doubled to up to 500 Wh.



## POWERFUL AND SAFE WITH INTEGRATED SUPERNOVA LIGHTING SYSTEM

VELLO offers a wide range of perfectly matched accessories designed for everyday use. Its modular system allows removable front and rear racks with practical MIK mounts that can be combined flexibly and offering maximum convenience for carrying cargo. Foldable mudguards provide reliable protection in all weather conditions, while the SUPERNOVA lighting system ensures visibility day and night, powered directly by the main battery. A functional cockpit with an integrated smartphone holder, an adjustable stem and a sturdy kickstand complete the setup.



## FOLDABLE WITHOUT COMPROMISE. COLUMBUS TUBING AND MTB-TESTED

VELLO folding bikes combine refined frame geometry with a patented folding mechanism that allows for fast, folding. At their core are exceptionally robust chromoly frames made from high-quality tubing by the renowned Italian manufacturer Columbus Tubi. The frame, all components and the complete bicycle are tested and certified according to ISO 4210 MTB standards for mountain bike use.

Unlike conventional folding bikes, VELLO bike has a diamond, hinge-free frame. This preserves torsional stiffness, stability and the familiar ride feel of a full-size bicycle. Thanks to its carefully engineered construction, the bike still folds quickly and compactly, without compromising riding performance. Guided by the principle "Folding Bike for Cyclists", VELLO brings together true riding dynamics and urban flexibility

## COMFORT FOR EVERYDAY URBAN RIDING, EXTRA-WIDE BIG APPLE TYRES

A remarkably comfortable ride is achieved through the combination of premium materials and thoughtfully integrated damping elements. The precision-crafted Chromoly steel and titanium frames naturally absorb vibrations and road impacts thanks to their inherent elasticity.

This effect is further enhanced by wide Schwalbe Big Apple tyres, while integrated RaceGuard puncture protection ensures maximum reliability. Another key feature is the elastomer integrated into the rear-wheel locking mechanism: a powerful magnet securely connects the rear wheel to the frame while riding, while the integrated elastomer acts as a mechanical suspension element, helping to absorb vibrations and improve ride comfort.



MODEL	VIA+ TOUR (10-speed chain drivetrain)	VIA+ URBAN (2-speed belt drive)
FRAME	Chromoly steel, heat-treated COLUMBUS precision tubing	
COLOURS	Anthracite	
SHOCK ABSORBER	Shock absorber with elastomer-magnet folding system	
HANDLEBAR AND GRIPS	Foldable handlebar, VELLO BIKE design, and ergonomic grips	
SADDLE	Selle Royal saddle, Foam Matrix	
SEATPOST	Aluminium, 30.9 mm x 500 mm / 1.22" x 19.7", optional 600 mm / 23.6"	
STEM	Fully adjustable, VELLO BIKE design	
DRIVE	Shimano Chain	Gates Carbon Drive Belt
REAR DERAILLEUR	Shimano Deore XT 10-Gang	UTgear H2
SHIFTER	Deore Rapidfire (right)	UT Shifter
MOTOR	BOSCH HubLine BDU3061	
BRAKE SYSTEM	Low-maintenance hydraulic disc brakes	
TYRES	Schwalbe Motion Big Apple 20 x 2.00, ETRTO 40-406	
DEVELOPMENT	2.60 m – 7.56 m / 8.5 ft – 24.8 ft	3.38 m – 4.74 m / 11.1 ft – 15.6 ft
PEDALS	Full-aluminium folding pedals	
WEIGHT	16.5 kg / 36.4 lbs (approx., without pedals, +/- 5%)	16.9 kg / 37.3 lbs (approx., without pedals, +/- 5%)
FOLDED SIZE	H: 57 cm / 22.4" x L: 79 cm / 31.1" x W: 29 cm / 11.4"	
LENGTH UNFOLDED	150 cm / 59.1"	
MAX. PERMISSIBLE TOTAL WEIGHT	125 kg / 276 lbs	



**DESIGNED IN AUSTRIA**  
**MADE IN EUROPE**



PRESS PHOTOS: [https://drive.google.com/drive/folders/1TdH6pv8-uSZM9t\\_wLhZuGSunByM0LOEx](https://drive.google.com/drive/folders/1TdH6pv8-uSZM9t_wLhZuGSunByM0LOEx)  
PRESS CONTACT: VELLO GMBH/VALERIE WOLFF/TEL. +436605556223/PRESS@VELLO.BIKE