

# NATIONAL URBAN PARK OF QUEBEC

# PARC DES QUATRE RIVIÈRES

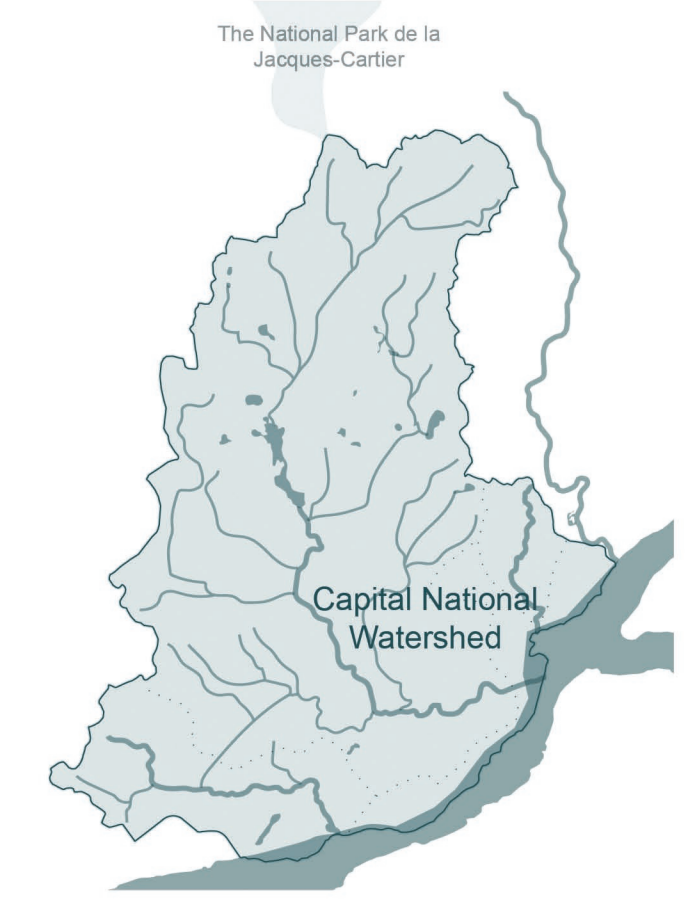

A guide to making Quebec a Water City

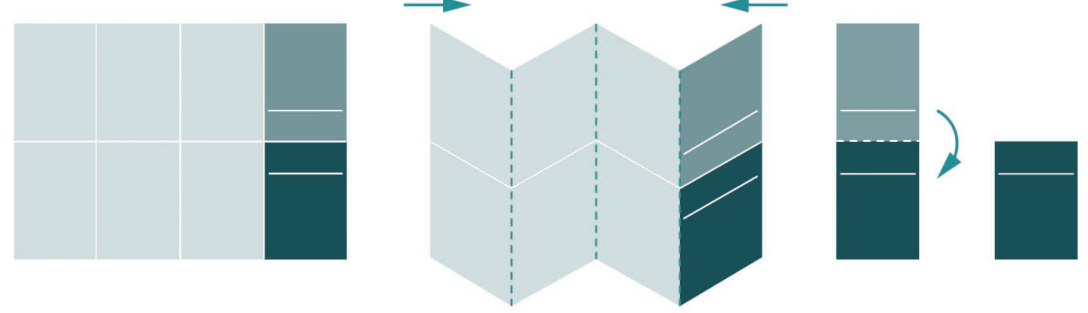

## NATIONAL URBAN PARK

A National Urban Park is a collection of naturally, culturally, and agriculturally important landscapes. All can be found within the Capital National Watershed and even more so in the City of Quebec!



Landscapes of a National Urban Park

Our proposal works at multiple scales to deliver a guide for transitioning the Capital National Watershed into a National Urban Park. This guide outlines a series of large and small scale measures which can be employed during the process of making Quebec a Water-City.

Canada has a rich history of developing national parks, protecting land for public understanding, appreciation and enjoyment, and maintaining iconic landscapes for the unborn generations. The Parc des Quatre Rivières can be used as a new bio-physical border within and around the city which can influence the city to grow towards its rivers, and blur the lines between the natural and the urban.

The park is based on the philosophy of Every Man's Right, and is realized through four strategies: Lines, Patches, Points, and Plugs.

The four strategies and the over-arching umbrella of the National Urban Park work both in the short-term and long-term with varying levels of interventions, and have different natures physically. They are the eyes which overlap to create a symbiotic approach to revive, transform, engage, and activate the public to the diversity of the riparian landscapes in the region.

The advantages that can be gained from maintaining a national urban park include: ecological health, sustainability, contact with nature, education, public engagement, respect and partnerships, diversity, local heritage, and a common understanding of urban ecology.

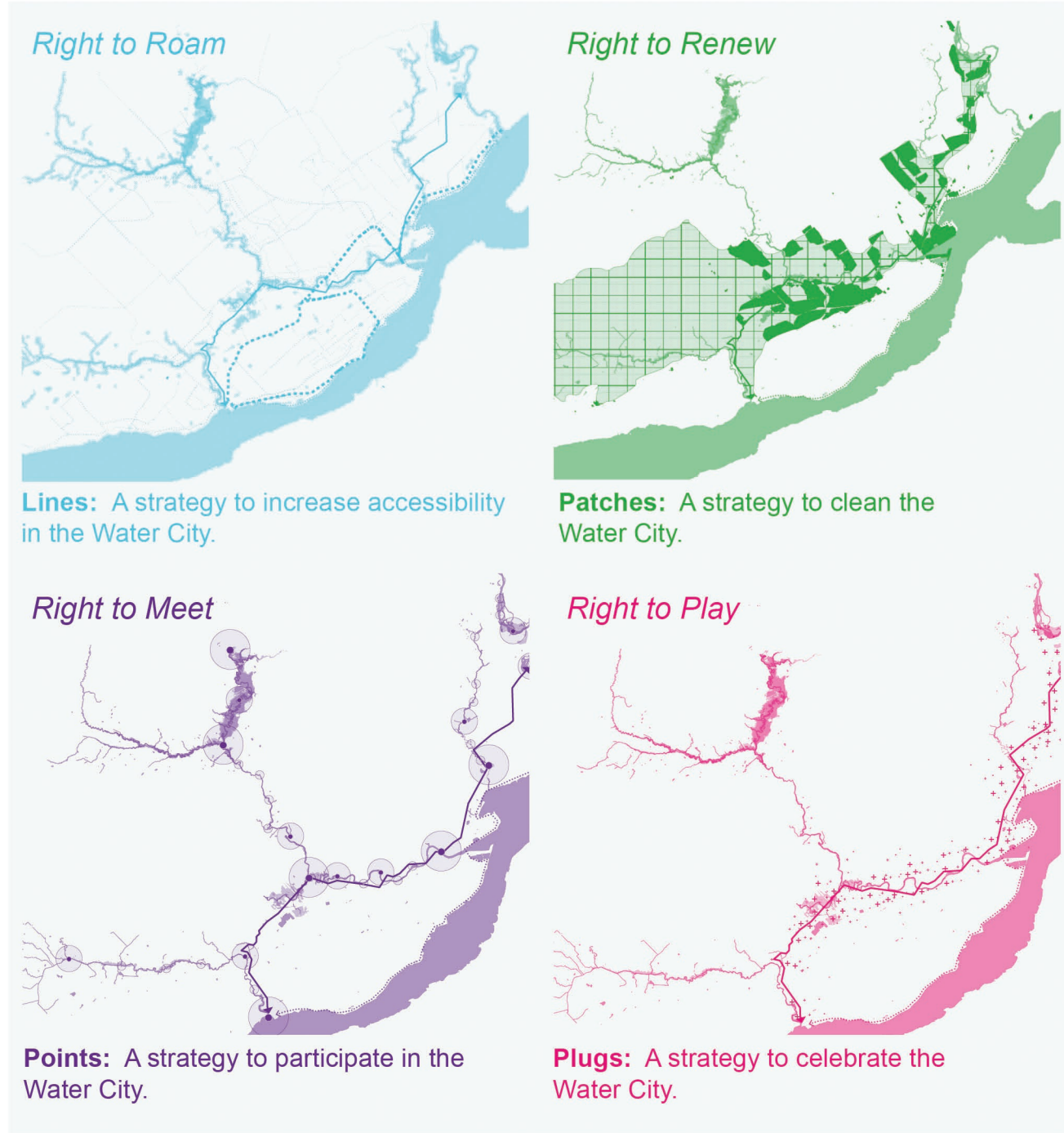

Four Strategies

## BACK TO THE RIVERS

The first settlements in Quebec city were intricately linked to the rivers. More recent development in the form of sprawl, however, has caused a disconnect with the river and Quebec City's neighborhoods. By drawing a border around the city's natural, cultural and agricultural landscapes, we can put a cap on sprawl and begin to densify more sustainably within the city's existing fabric. Densification and re-development opens an opportunity for the city to create a new relationship to its rivers.

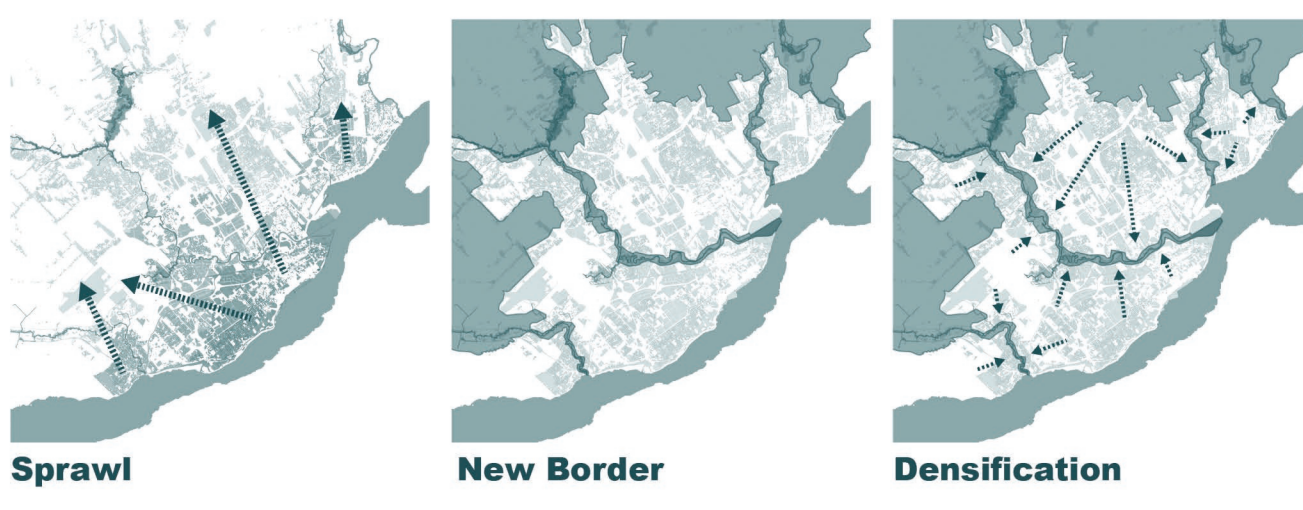

Sprawl, New Border, Densification

## EVERY MANS RIGHT

The Rivers have been privatized due to industry and residential development. In order to make Quebec a Water City the people need to interact, explore and enjoy the rivers. As a tool to work with private and public landownership it is suggested to adopt the Scandinavian model of the right to roam. This change in policy can be used to develop a public stewardship towards the rivers, and increase access to the riparian corridors, enhancing an appreciation for nature and water in the city.

Public access need not burden the municipality with the brunt of financial strains. Implementation can be driven by the public sector, but also adopted by public-private and private citizen involvement. While the rivers themselves and some of the natural and cultural landscapes may fall within the city's scope, some of the industrial and agricultural transformation can be encouraged within the private sector through tax incentives, for example. Public art and digital platforms can be entirely operated by community groups who wish to 'plug in' to the city's collective transformation effort.

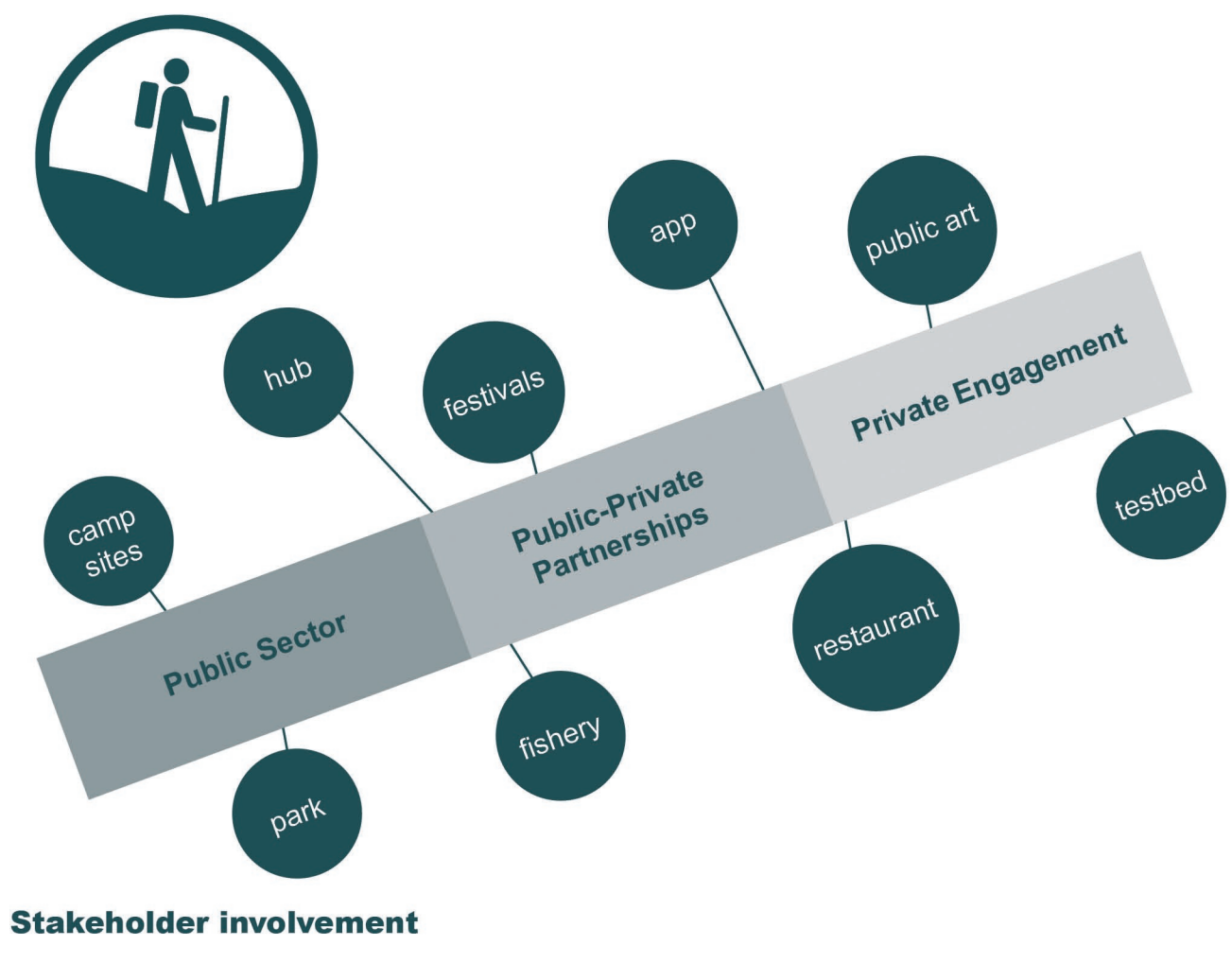

Stakeholder involvement

## IDENTITY & HALLMARKS

Quebec's rivers are its life veins! However, today they are the forgotten souls of the city. Quebec has one of the strongest identities out of any city in Canada. Its rivers deserve the same! The rivers will be the highlights of the city. The basins collect diversity, are explored, cared for and become integral to the environmental and socially resilient future of Quebec. All of the rivers have unique identities and opportunities waiting to be re-discovered and shared with the world.

Float down the Cultural Cap Rouge. Celebrate along the Saint Charles. Get productive on the Beauport. Tame Montmorency the Wild. Enjoy the Water City & Parc des Quatre Rivières!

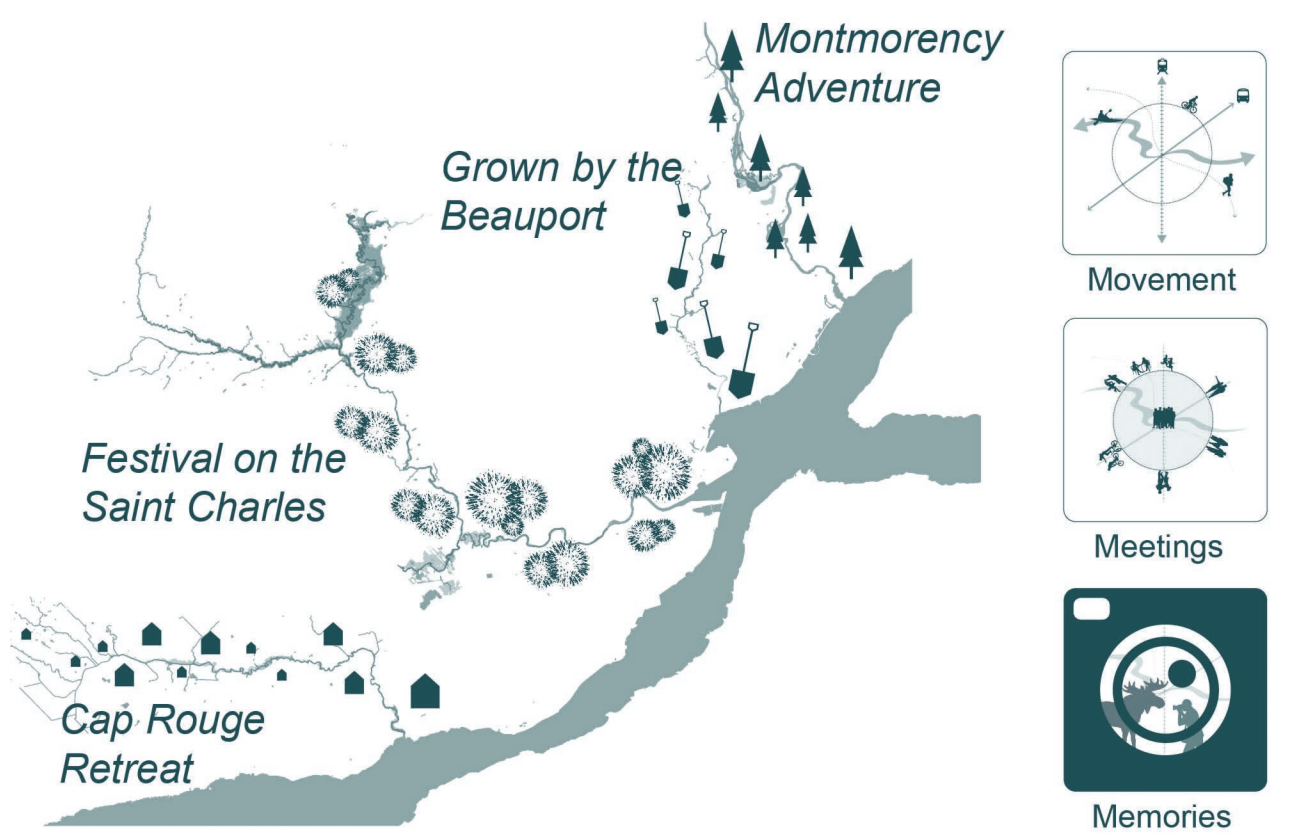

**LEGEND**

- Lines
  - Train (Blue Line)
  - River Corridors
  - Green Mobility Network (existing)
- Patches
  - Productive Transformation Areas
- The Green Thread
  - Promenade Samuel de Champlain
- Points
  - Small Hubs
  - Large Hubs
  - Super Hubs
- Plugs
  - Installation / Information
- Area of Interest
  - CR1
  - GT1
  - SC1
  - B1
  - M2
- Water
  - Rivers
  - Lakes
  - Watershed

0 1 2 3 4km

**GOALS**

125 KM PUBLIC WALKABLE RIVERFRONT	100% GREEN MOBILITY	NET ZERO INDUSTRIAL FOOTPRINT	#1 IN ENVIRONMENTAL EDUCATION	SWIMMABLE RIVERS	30% FOOD SOURCED LOCALLY	NEW JOBS CREATED FROM PRODUCTIVE MARKETS	#1 SOCIAL CITY RANKING	100% USER PARTICIPATION IN THE CITY
--------------------------------------	------------------------	----------------------------------	----------------------------------	---------------------	-----------------------------	---	---------------------------	--

# Right to Roam



**Lines:**  
A strategy to increase accessibility to the Water City.

## ACCESSIBILITY + CONNECTIONS

This strategy aims to revive the city's life veins by enabling access to the water ways within Quebec and giving people the right to the river. The current ambitions of the city to create linear parks is one step in the right direction. However, as noted in the brief it can be difficult to access certain points due to ownership, terrain, and distances.

The Right to Roam philosophy re-categorizes the rivers as public space and invites the public to use this space as an initial test bed for policy. The right to the river has the ability to invite the public into the city's riparian networks and shift the rivers from being someone else's to everyone's.

Movement along and on the rivers is important to experience and embrace the qualities and identities embedded within them.

It is equally important to develop a bi-lateral connection that crosses and binds the rivers together across the city. Connecting the blue transportation network to the existing sustainable transportation network is critical.

Can Quebec have a kayak/canoe sharing network? Can a 'blue line' be initiated on the existing railway that provides a fast form of transportation to the rivers, and throughout the city?

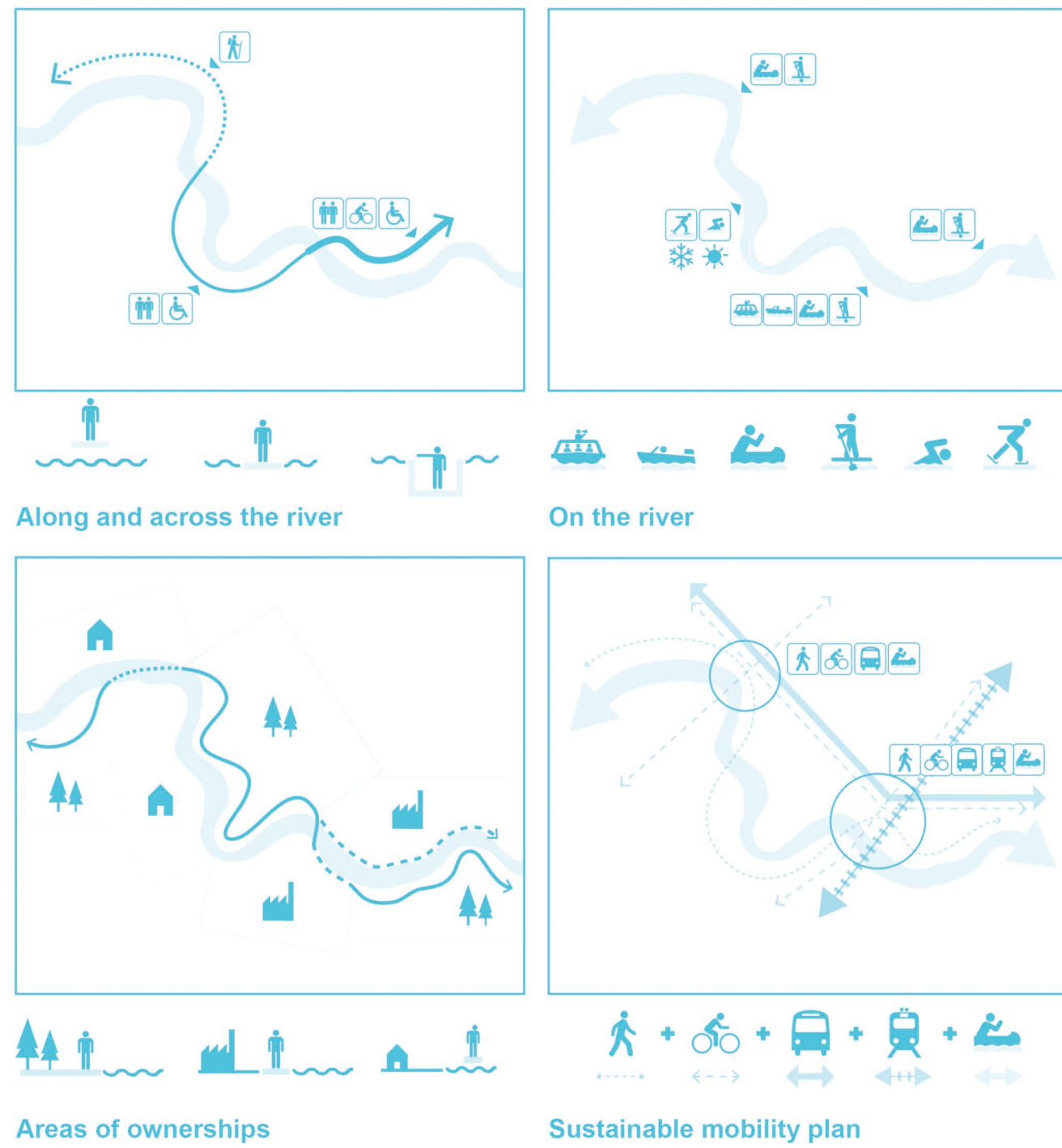

## MONTMORENCY LOOP

The infinite bridge has the ability to invite people into the endless panoramic landscape that the Montmorency has to offer.

The bridge provides a continuous ring of connectivity, and has the ability to enclose and bring down the scale of the site. The enclosed space is safe for children and beginners to canoe, kayak, swim, skate, play hockey, and enjoy throughout the seasons.

Walking or cycling along the bridge creates a space for social interaction and a physical connection across the river. Seating is placed along the bridge so that visitors, or travelers can slow down, rest, converse or quietly take in the breath taking landscape of the Montmorency.

In the future, if the sandpits to the west are developed with housing and mixed-use, the infinite bridge will provide a social and recreational platform that will have the ability to connect the inhabitants directly to the water.

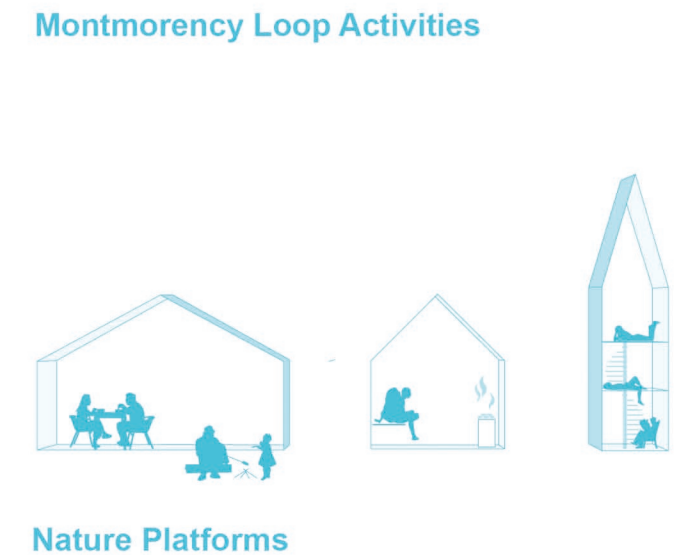
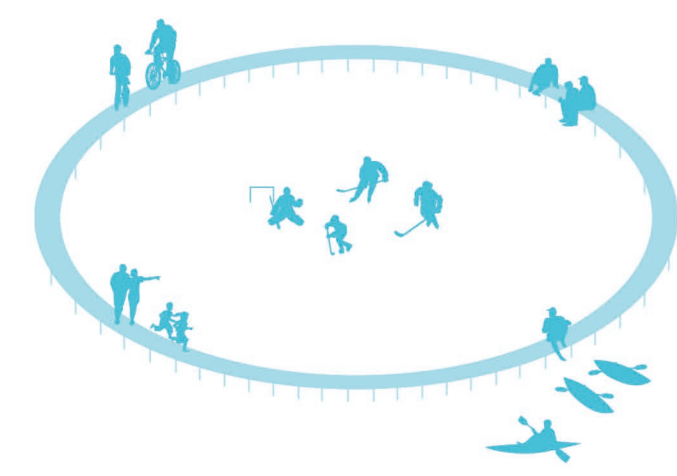
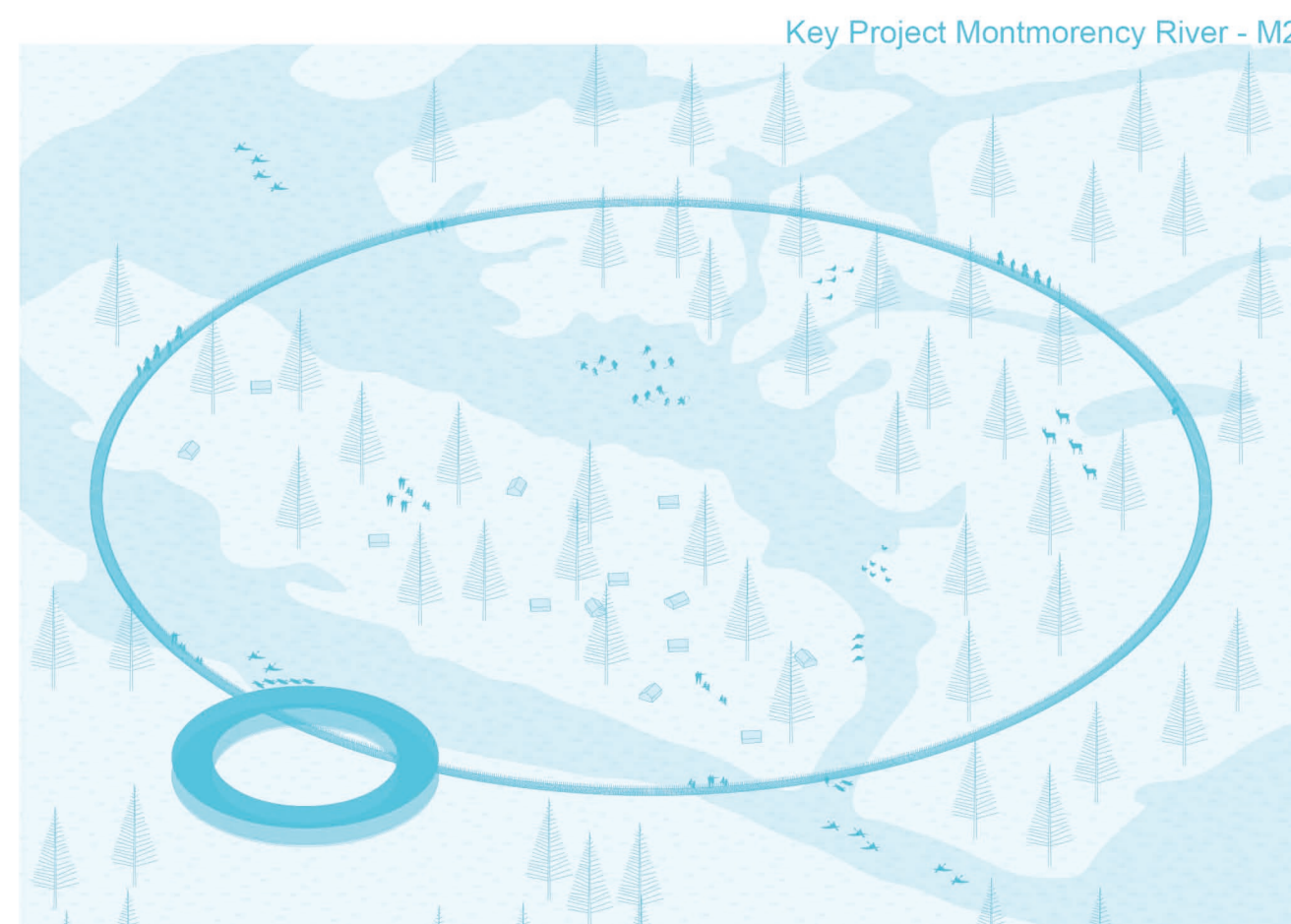

## REFERENCE PROJECTS



Infinite Bridge, Gjedde & Povlsgaard arkitekter | Drie Streken, Marc van Vliet | Floating Tent

# Right to Renew

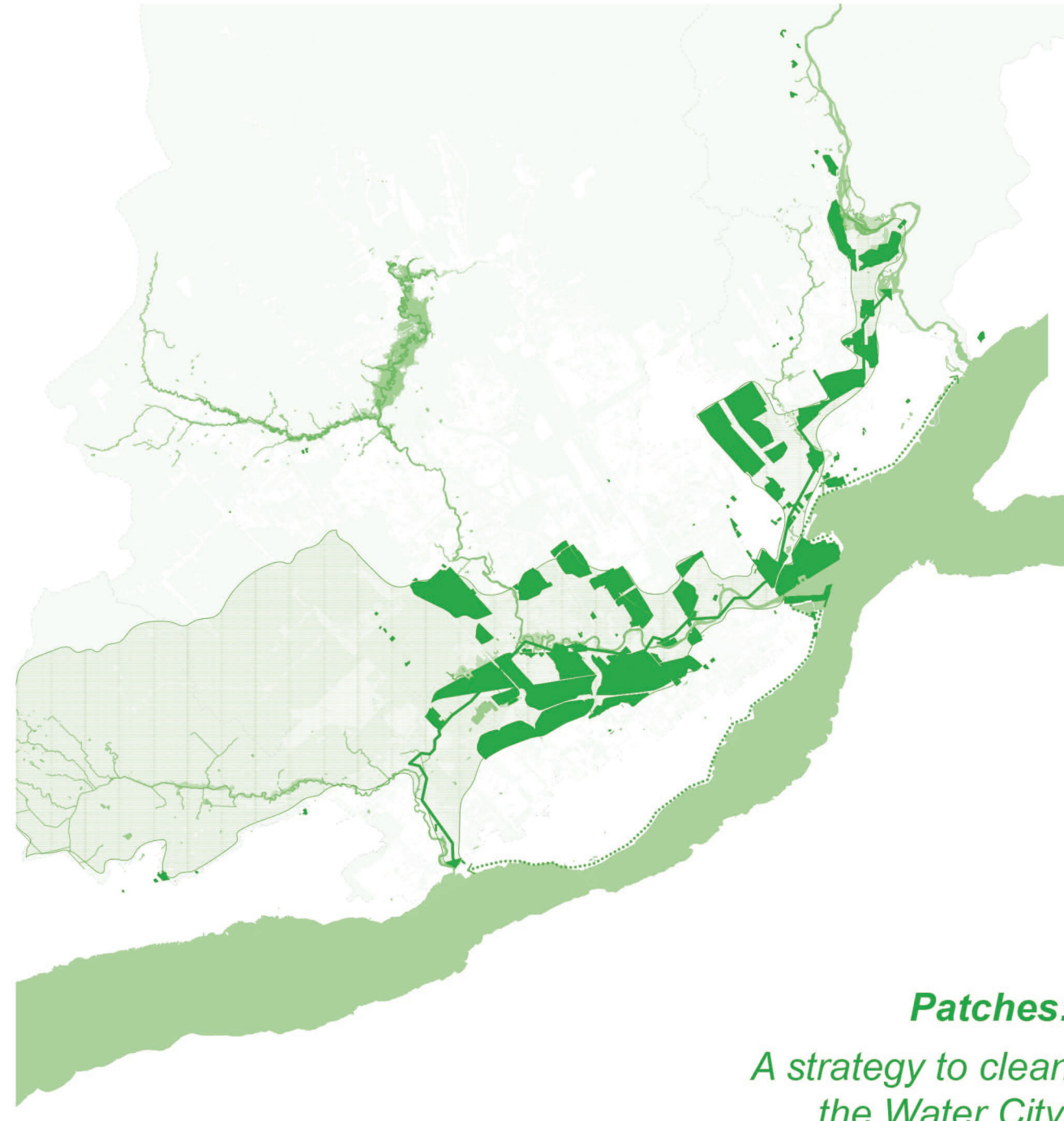
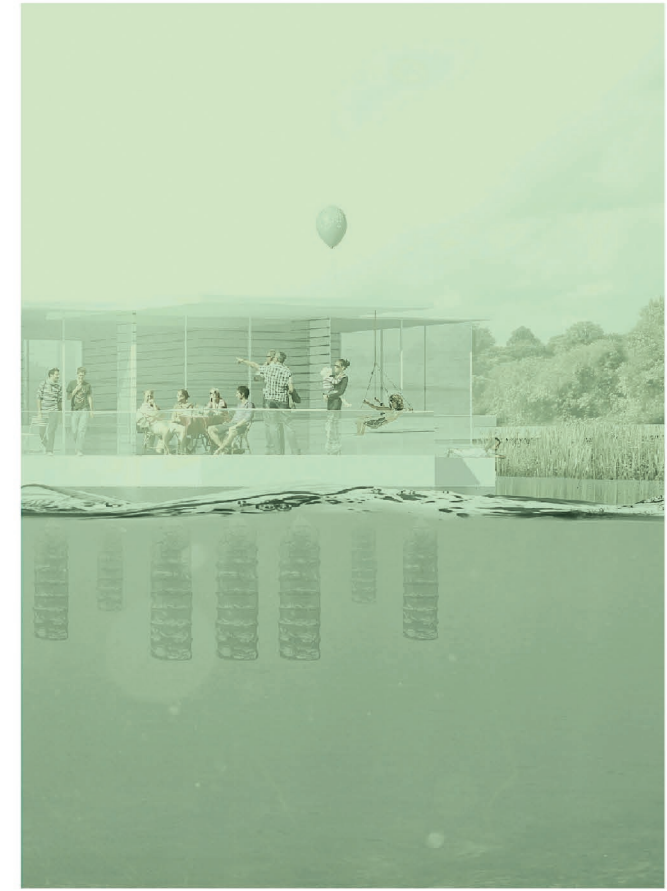

**Patches:**  
A strategy to clean the Water City.

## TRANSFORMATION + INNOVATION

The Green Thread is a transformation strategy for the industrial belt which runs across the city through the rivers into a new productive buffer for the city. It connects to the ongoing waterfront development along the Saint Lawrence (Promenade Samuel de Champlain), creating an urban loop.

The City of Quebec has promised a clean swimmable water in the Saint Lawrence River since the 1960's. By cleaning the four tributary rivers the city can come closer to its goal for the Saint Lawrence River.

The area within the green zone has the potential to become a hub for transformation and innovation within Quebec while simultaneously creating cleaner rivers. Topographically, The Green Thread is critical for the city's riparian systems.

Clean Industry = Clean Water

The valley contains some of the most fertile soil in the province providing an opportunity to create a new landuse pattern. Using methods of phytoremediation, adopting clean energy, promoting productivity, and providing a sustainable mobility link through the city and steps towards creating a resilient mosaic in the heart of the city.

Can Quebec become a leader in urban hydrology? A hub for climate adaptability? Can the 'Green Thread' enhance life in the city and on its waterways while creating new opportunities economically and ecologically?

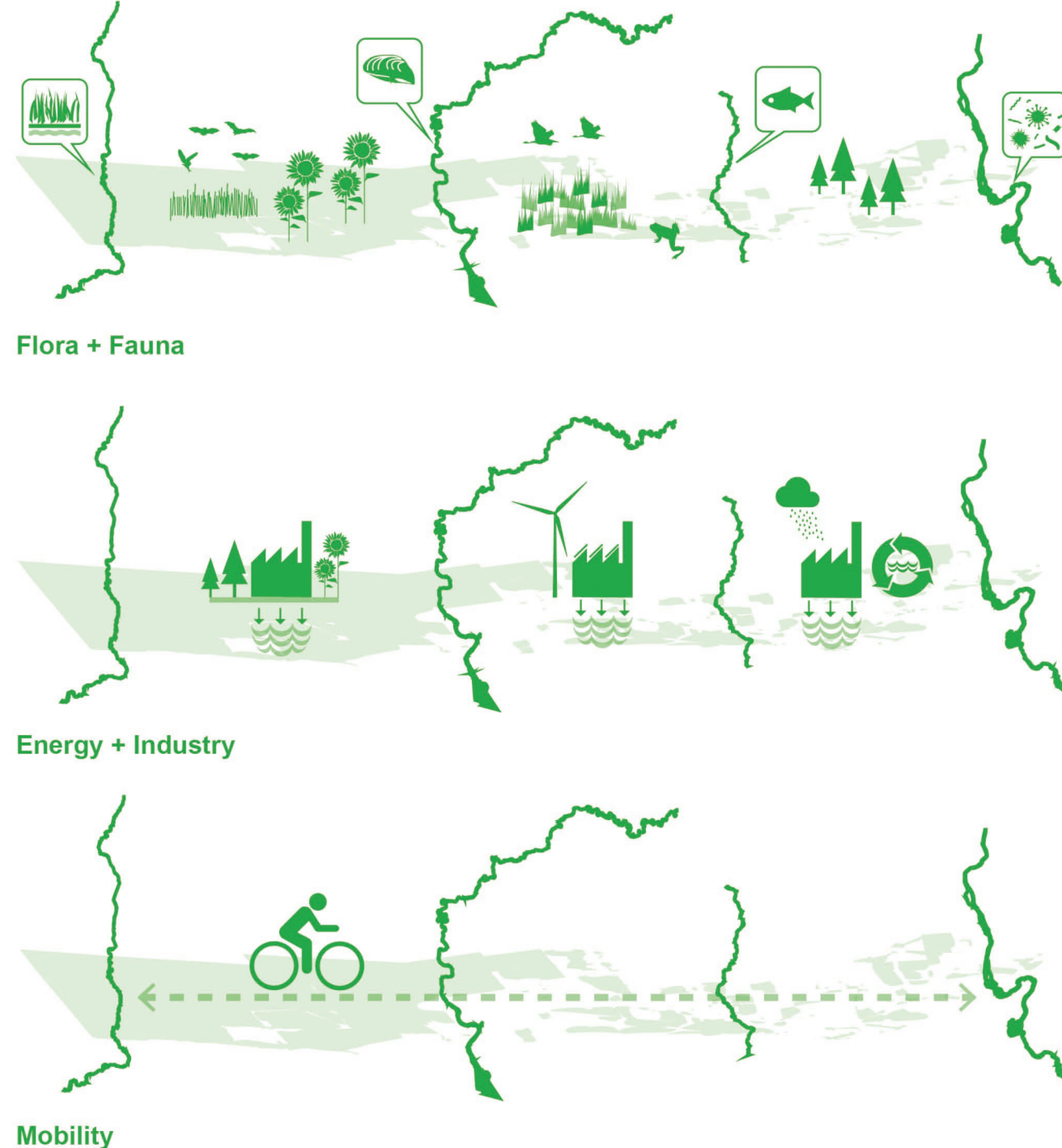

## THE MUSSEL SHACK

The mussel shack serves multiple purposes. From an ecological perspective the creation of a fresh water mussel reef in the river can provide a habitat for fresh water mussels to live in. The platform and small scale structure above to provide shelter and a gathering space on the Saint Charles river.

Why fresh water mussels? Fresh water mussels have the ability to filtrate polluted water and transform it to clean water. Over time, as water quality improves, the mussels will be safe enough to eat. Though this is not the one and only approach to creating clean water, it can create a necessary and interesting link between ecology and economy.

The Mussel Shack does not have to remain static, in fact the simple design of the floating reef can maneuver up and down the river and connect to a series of piers, making itself known along the Saint Charles.

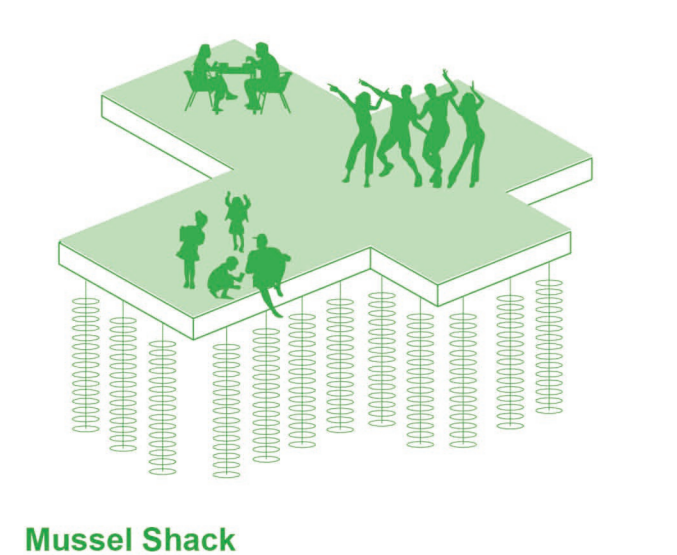
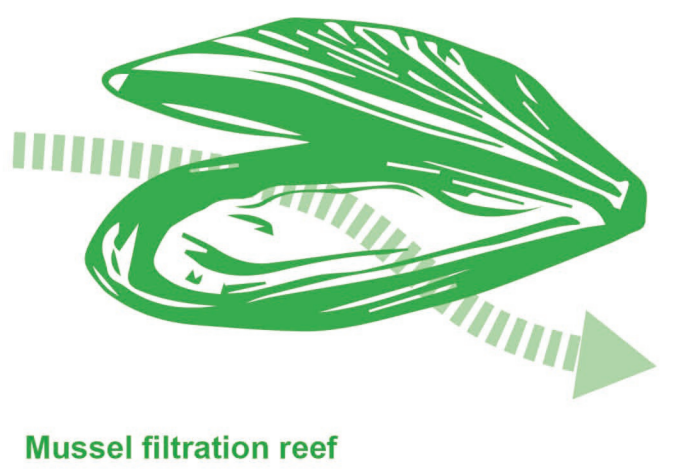
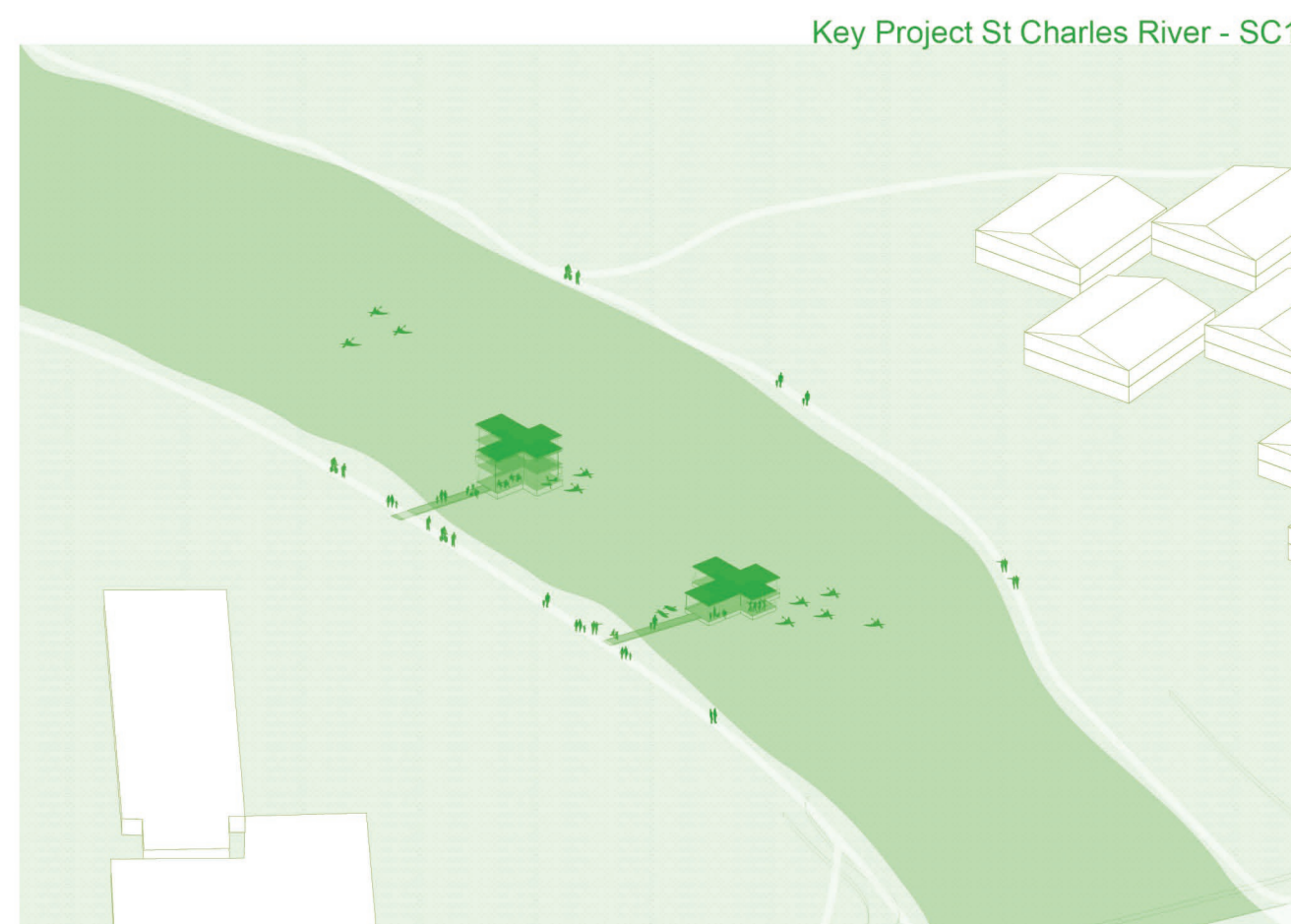

## REFERENCE PROJECTS



Oyster Reef, South Walton | Oyster Bar, Scope

# Right to Meet

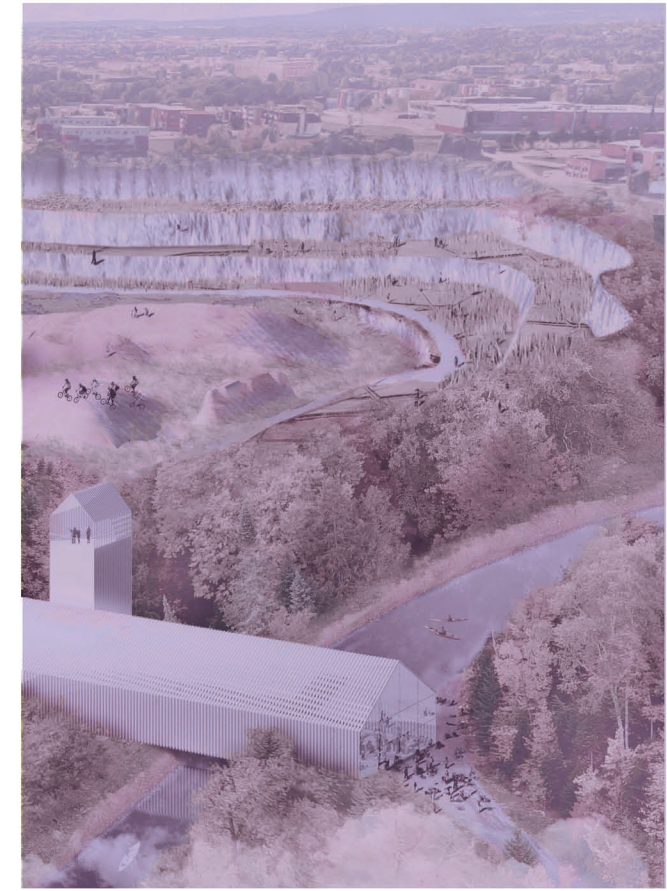

**Points:**  
A strategy to participate in the Water City

## EDUCATION + RECREATION

This strategy proposes a series of meeting points (River Hubs) located along each of the rivers.

River hubs are social platforms where one can experience, explore, learn, discuss and take part in a communal discourse surrounding the Cap Rouge, Saint Charles, Beauport, and Montmorency.

The river hubs are located at important crossing, or confluences, and are connected to the sustainable transportation network.

The scale of the river hub can vary from the size of a small deck, to a sauna, to a transportation hub, to larger scale centres. The goal is to highlight urban and natural qualities, as well as existing qualities specific to each rivers identity.

The vision is to provide spaces geared towards sustainability, a melting pot for citizens, businesses, academia and government, to turn 'what if's' into 'how to's'.

Can Quebec use its identity as a cultural hub to develop a culture surrounding its rivers? Can the hubs potentially make Quebec 'The Water city' a hub for national and global discussions surrounding climate change (flooding, sea level rise)?

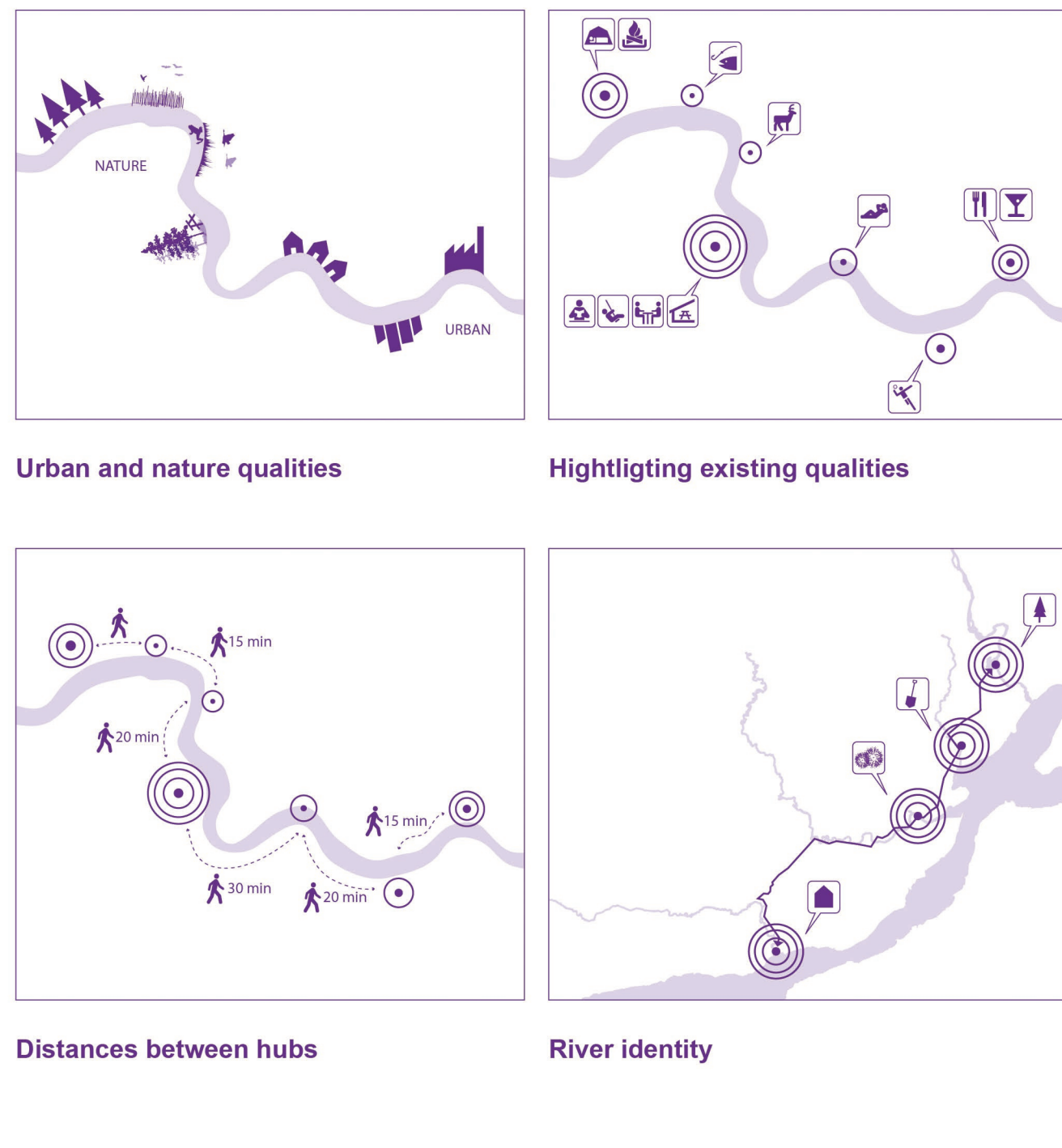

## BEAUPORT P.I.T.

Located at the heart of the Beauport River Linear Park, The Beauport P.I.T. (Public Innovation Terminal) can be found. The P.I.T. serves as a River Hub within the water city.

The P.I.T. is located within one of the many naturally beautiful areas in Quebec that is known for its large scale trees and rough waters.

The P.I.T. serves as a bridge across the beauport creating an east west connection. Its design is flexible and can host events, lectures, markets and more. To the north an observatory is placed where visitors can participate in birding, watching nature, and enjoying the grand views over the St. Lawrence River tidal flats.

The P.I.T. can provide a second life for the quarry. In the future the quarry can be used for recreational purposes, as well as a terraced productive landscape. The public will have the ability to program the quarry, or to allow a new ecology to emerge over time.

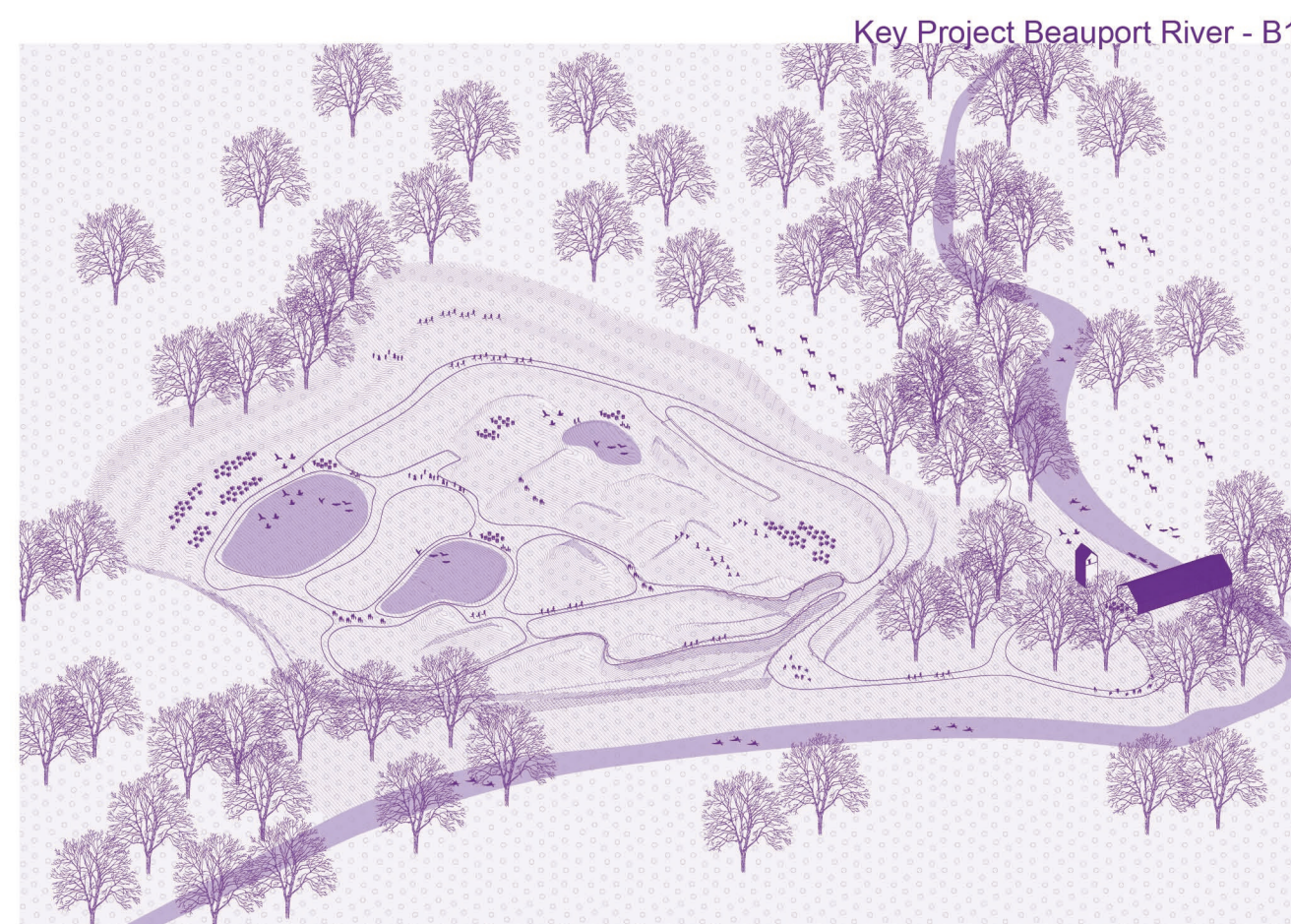

## REFERENCE PROJECTS



Garraf Waste Landfill, Battle i Roig | Evergreen Brick Works, Diamond Schmitt Architects

# Right to Play

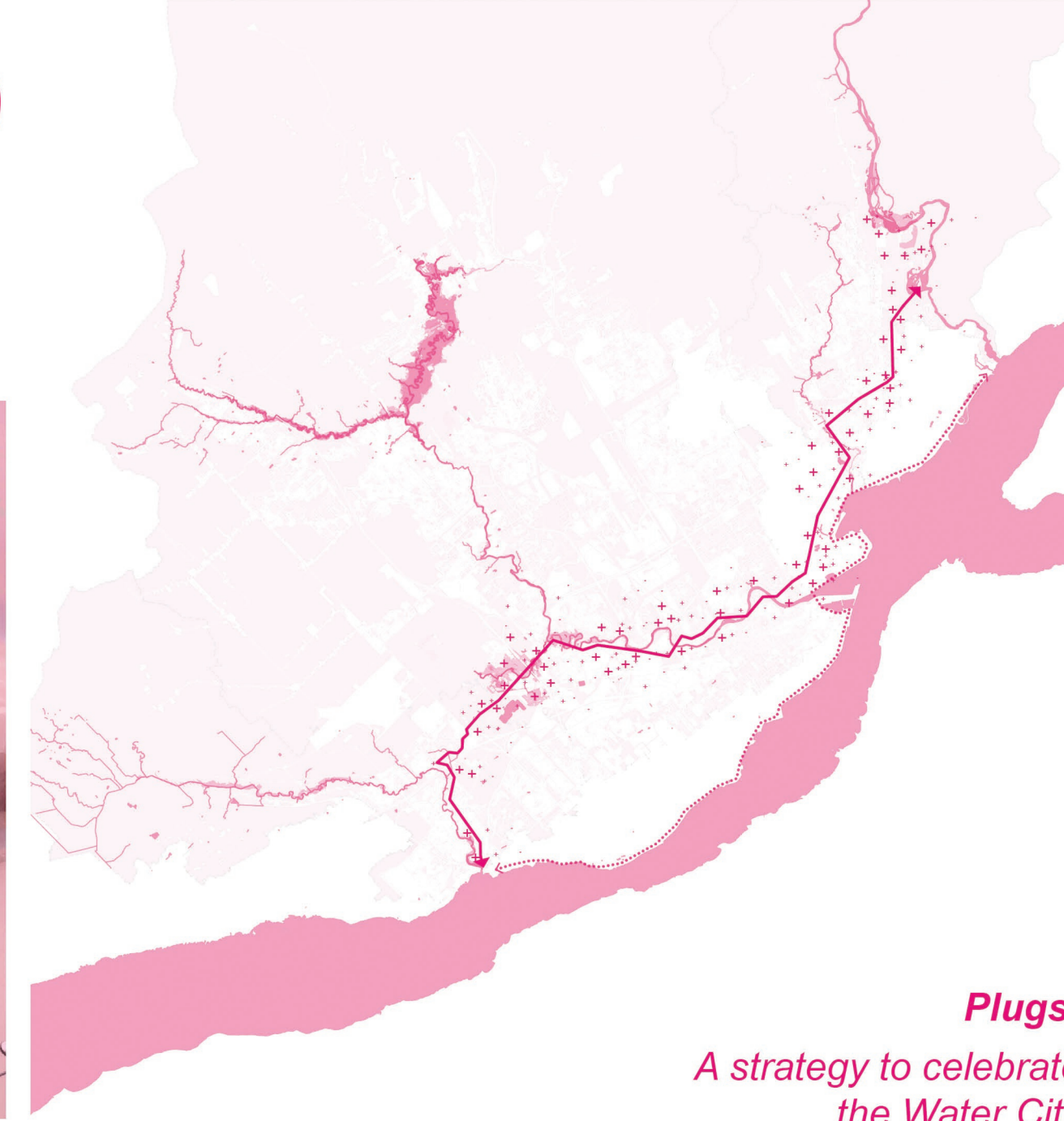

**Plugs:**  
A strategy to celebrate the Water City

## ENGAGEMENT + PERFORMANCE

This strategy is an artistic and digital platform to promote engagement and performance, combining art and technology to broadcast the rivers throughout the City of Quebec.

The scale of Quebec is expansive, it is simply not possible for every neighbourhood to have a physical or visual connection with the rivers. Connecting people to the rivers while they are moving between them becomes critical to developing a water city.

Citizens and visitors will gain access to the rivers through the use of small scale interventions such as information points, events, gathering spaces, testbeds and artistic installations.

The placement of the interventions have been specifically located along the green thread. This can provide low threshold method of engagement with the community and a common visual link that can be used in the initial planning process of the green thread.

How can interaction work as a public catalyst in the planning process? Can the city create river apps to give and gain knowledge about its watershed?

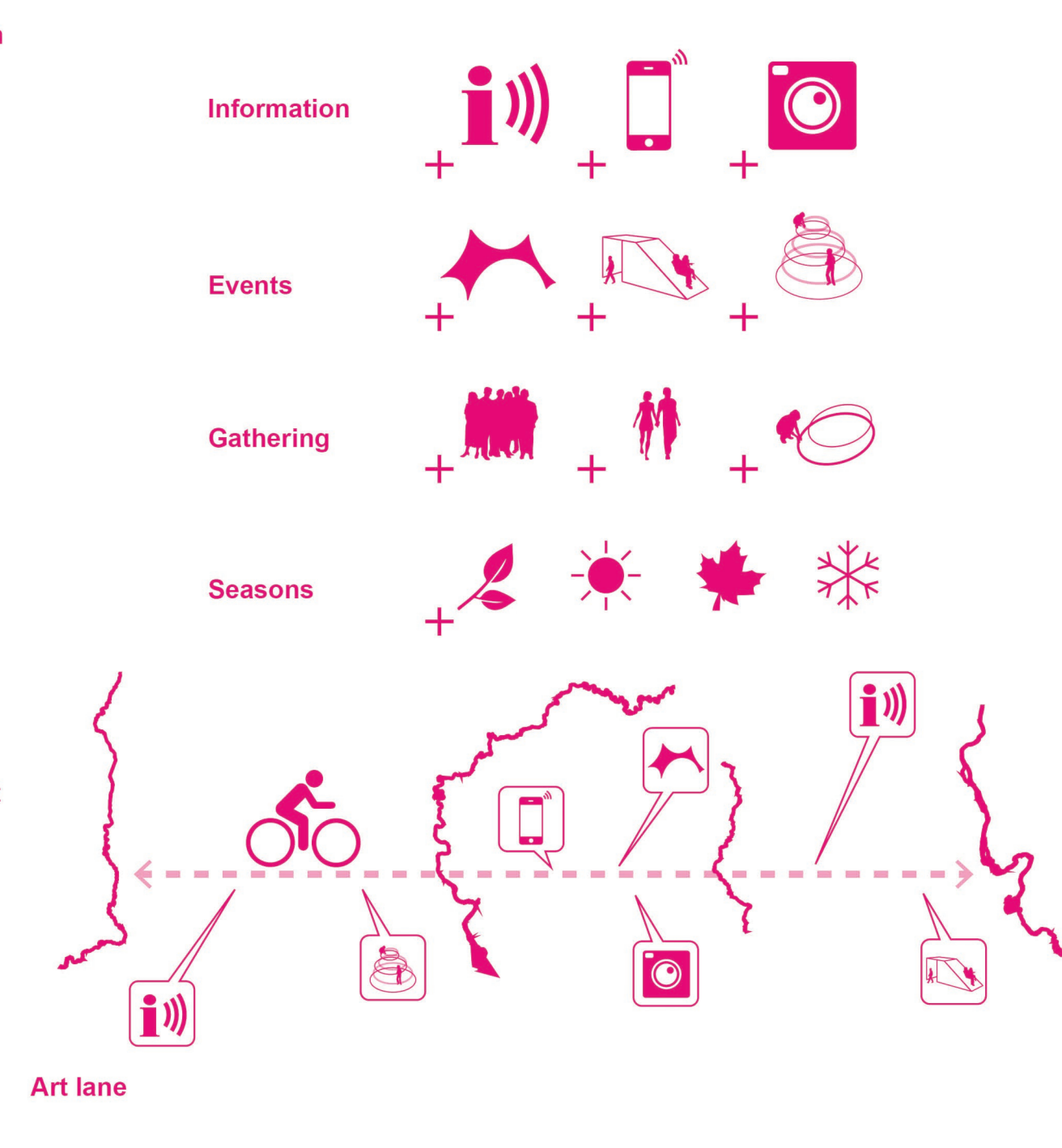

## MIGRATING MOOSE

The migrating moose is a symbolic artistic installation. It is used to mark areas of transformation along the green thread, and provide the public with information about the four rivers.

The moose serves as a provocative tool to engage the public and create awareness about what possibilities, opportunities and projects are underway within the city. There could be multiple moose to mark several points of transformation, or simply one which moves around on the thread, creating awareness and gives residents a fun outing to do on a weekend—let's go find the moose!

The Migrating Moose provides wifi, information, and a visual connection through the large scale landscape between the Cap Rouge and the Montmorency.

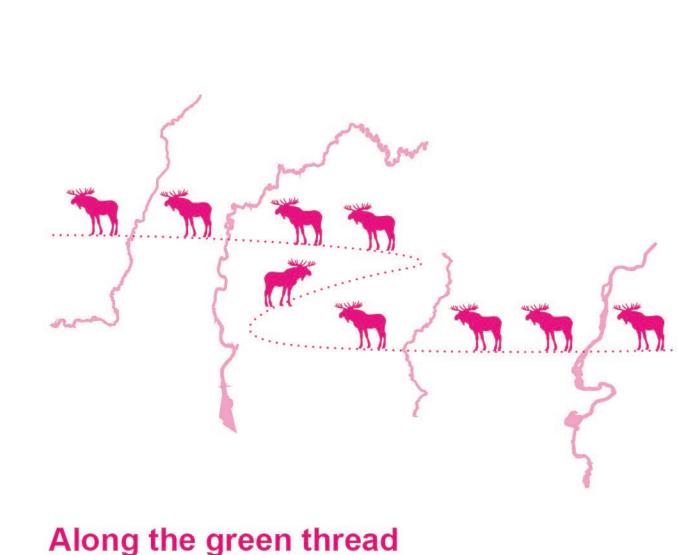
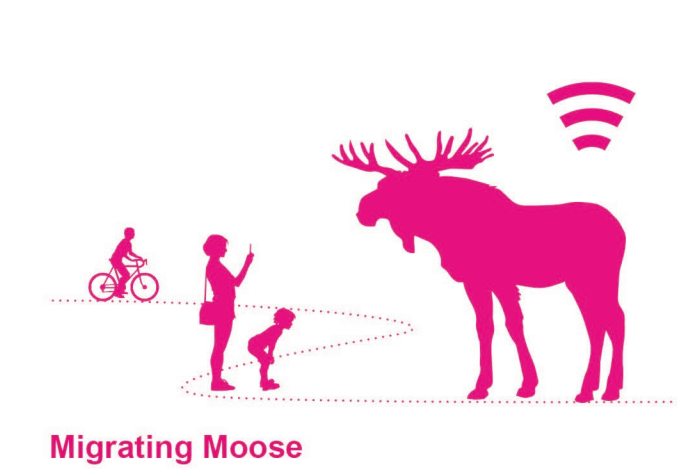
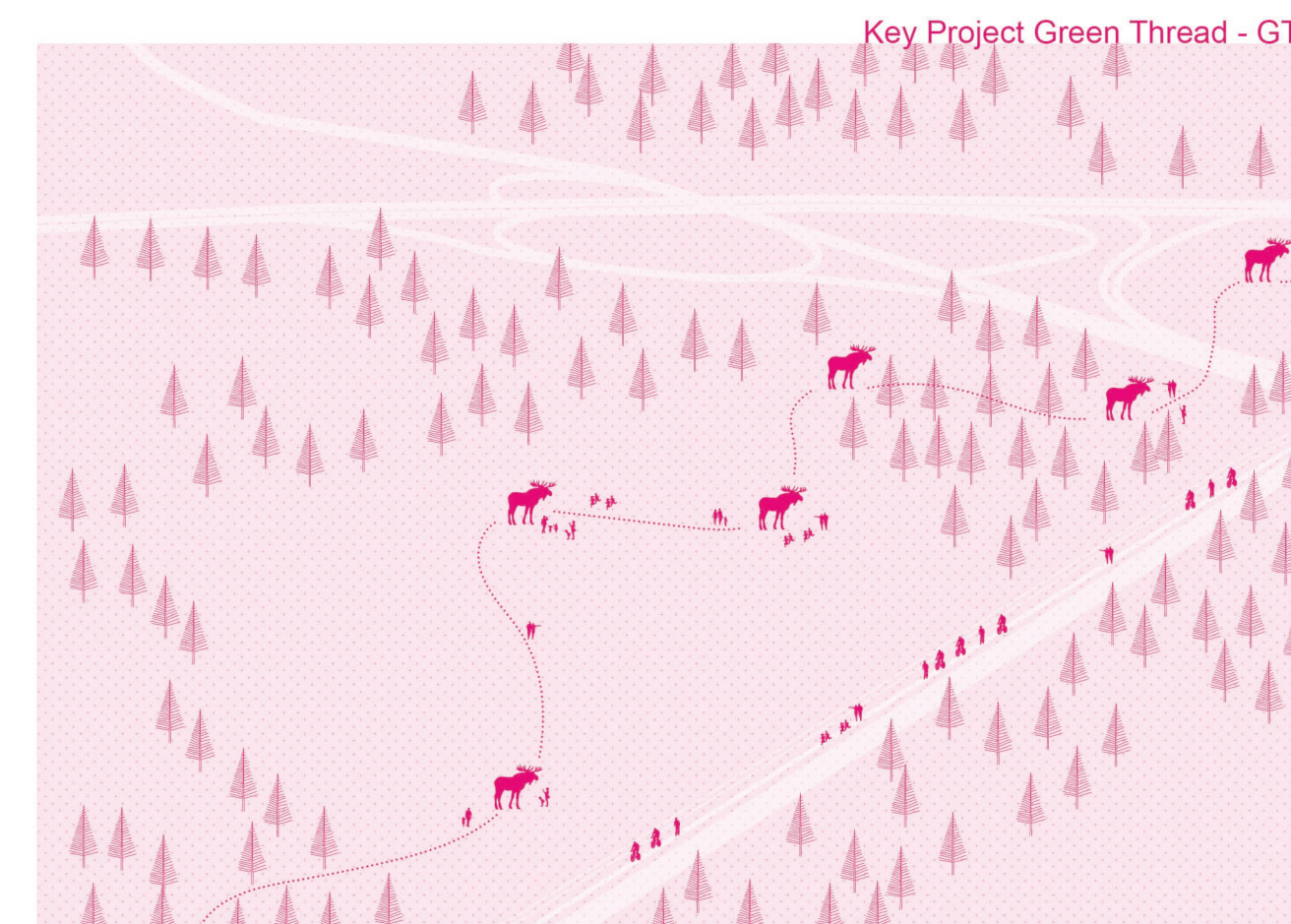

## REFERENCE PROJECTS



Oslo Havnepromenaden, Halogen, MMW and Bjarbekk & Lindheim | Sugar Beach, Claude Cormier + Associates | Cow, West 8, Holland

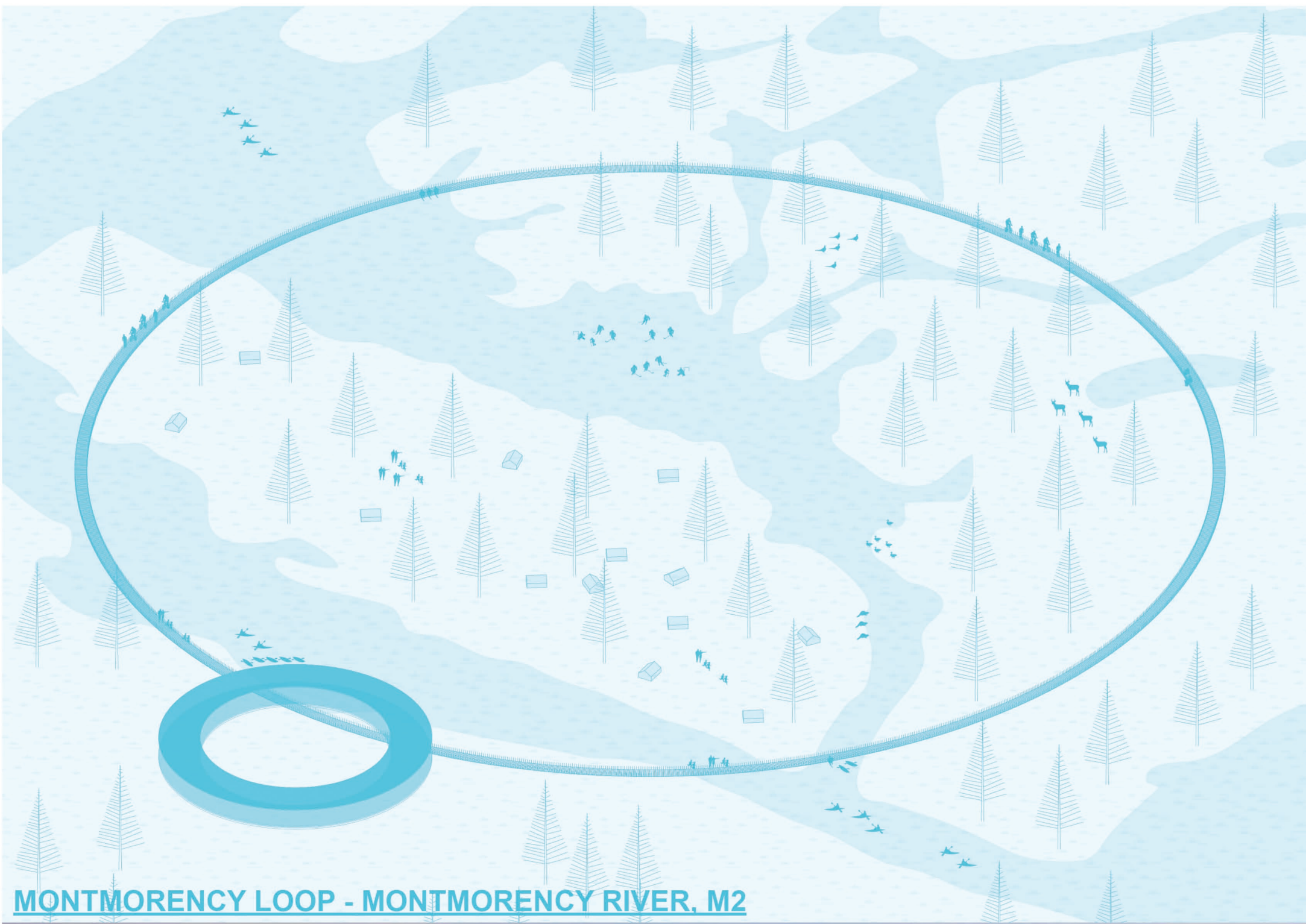

MONTMORENCY LOOP - MONTMORENCY RIVER, M2



FLOATING RETREAT - CAP-ROUGE RIVER, CR1



THE MUSSEL SHACK - ST. CHARLES RIVER, SC1



RIVER FOOD FESTIVAL - ST. CHARLES RIVER



MONTMORENCY LOOP - MONTMORENCY RIVER, M2



THE MUSSEL SHACK - ST. CHARLES RIVER, SC1

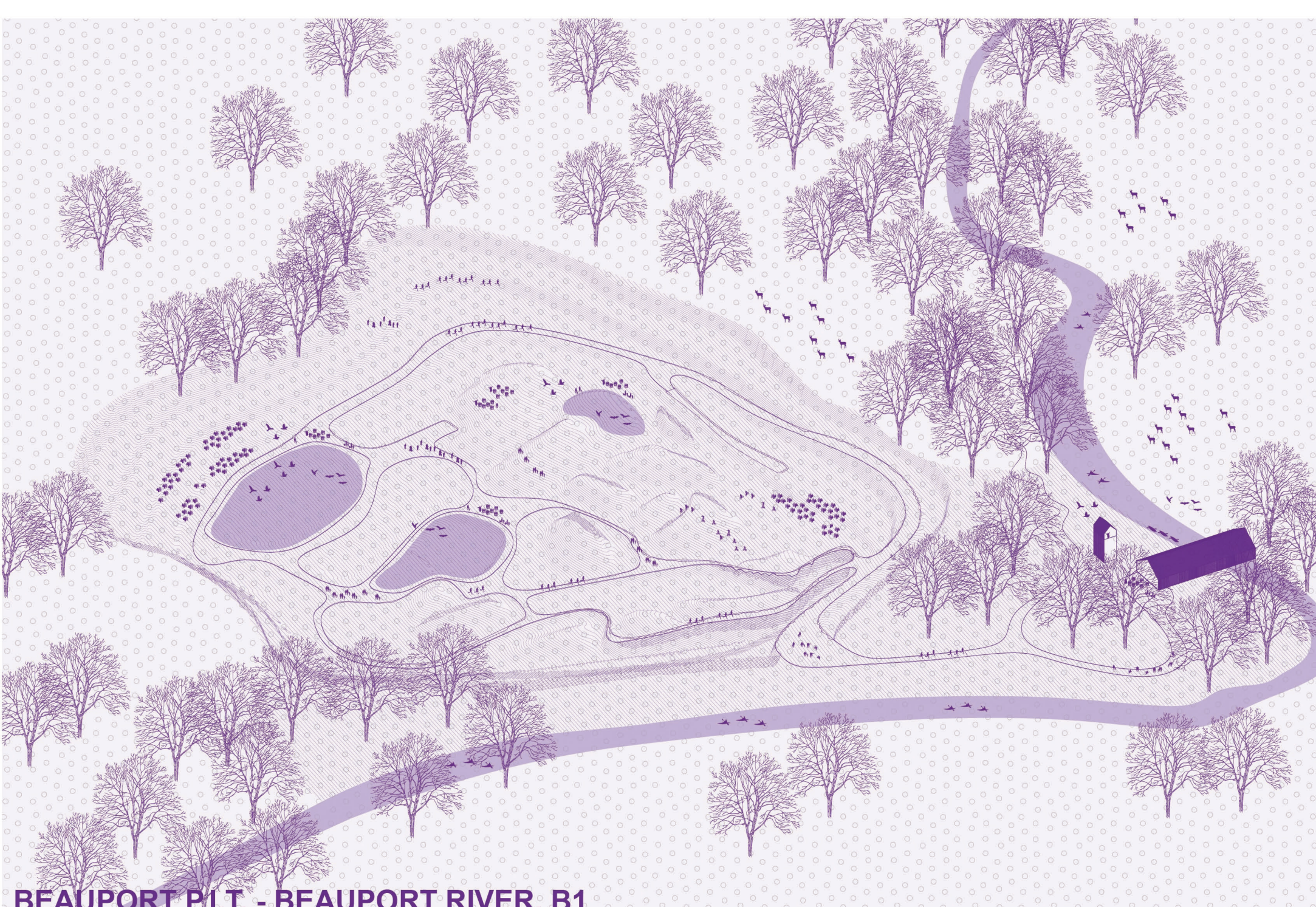

BEAUPORT P.I.T. - BEAUPORT RIVER, B1



BEAUPORT P.I.T. - BEAUPORT RIVER, B1

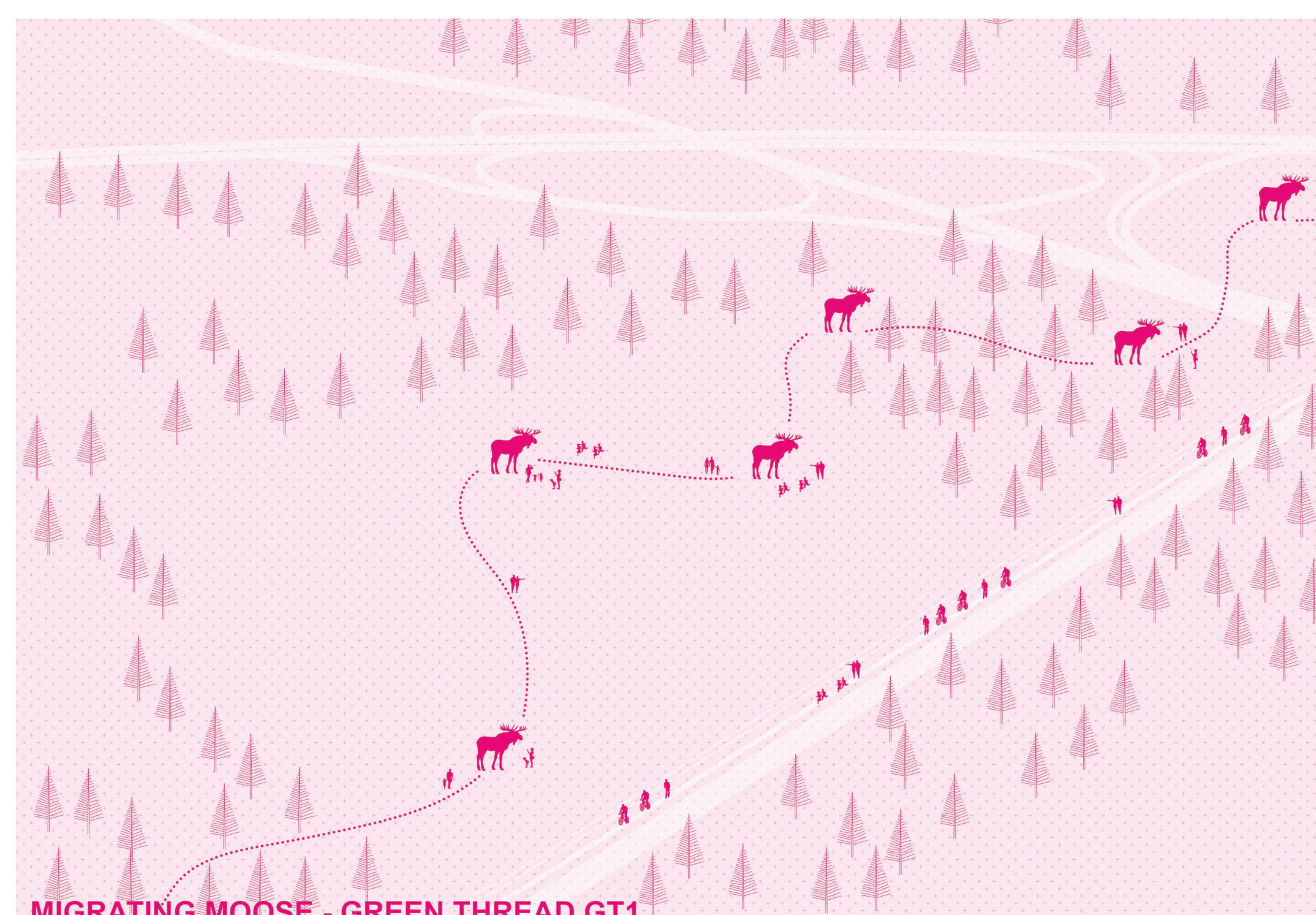

MIGRATING MOOSE - GREEN THREAD GT1



MIGRATING MOOSE - GREEN THREAD, GT1



BEAUPORT P.I.T. - BEAUPORT RIVER, B1

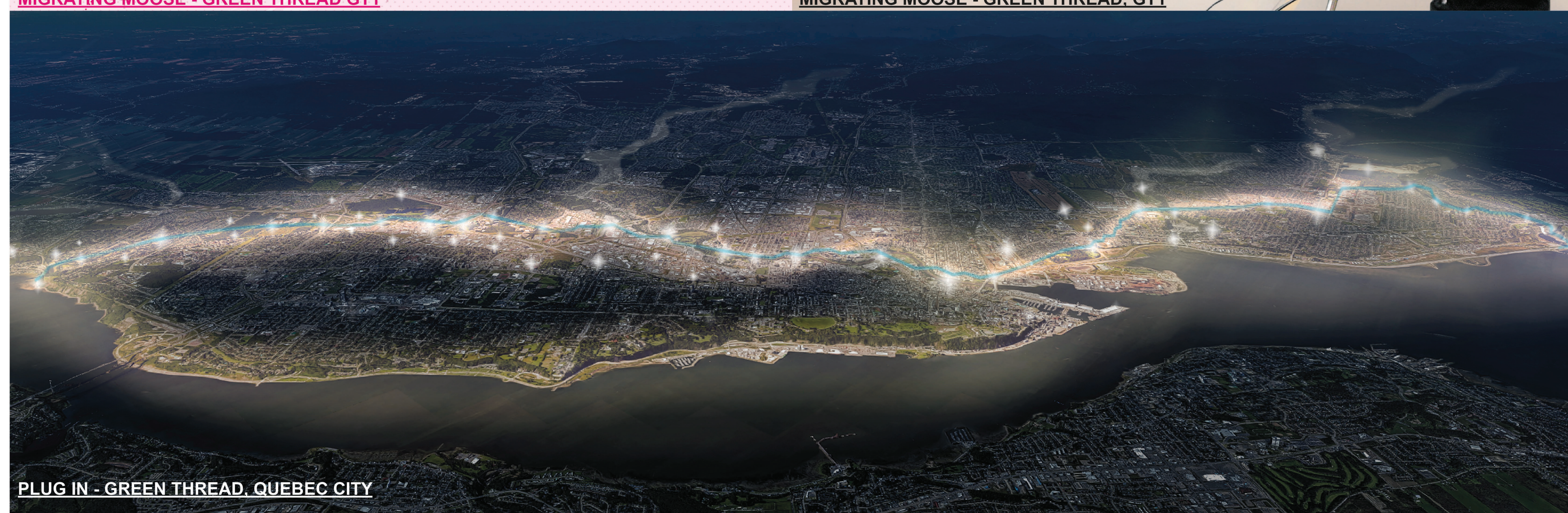

PLUG IN - GREEN THREAD, QUEBEC CITY

## PARC DES QUATRE RIVIÈRES NATIONAL URBAN PARK OF QUEBEC

*A National Urban Park is a collection of naturally, culturally, and agriculturally important landscapes. All can be found within the Capital National Watershed and even more so in the City of Quebec!*

Our proposal works at multiple scales to deliver a guide for transitioning the Capital National Watershed into a National Urban Park. This guide outlines a series of large and small scale measures which can be employed during the process of making Quebec a Water-City.

Canada has a rich history of developing national parks, protecting land for public understanding, appreciation and enjoyment, and maintaining iconic landscapes for the unborn generations. The Parc des Quatre Rivières can be used as a new bio-physical border within and around the city which can influence the city to grow towards its rivers, and blur the lines between the natural and the urban.

The park is based on the philosophy of Every Man's Right, and is realized through four strategies: Lines, Patches, Points, and Plugs.

The four strategies and the over-arching umbrella of the National Urban Park work both in the short-term and long-term with varying levels of interventions, and have different natures physically. They are the layers which overlap to create a symbiotic approach to revive, transform, engage, and activate the public to the diversity of the riparian landscapes in the region.

The advantages that can be gained from maintaining a national urban park include: ecological health, sustainability, contact with nature, education, public engagement, respect and partnerships, diversity, local heritage, and a common understanding of urban ecology.

*Quebec's rivers are its life veins!*

However, today they are the forgotten souls of the city. Quebec has one of the strongest Identities out of any city in Canada. Its rivers deserve the same! The rivers will be the highlights of the city. The basins collect diversity, are explored, cared for and become integral to the environmental and socially resilient future of Quebec. All of the rivers have unique identities and opportunities waiting to be re-discovered and shared with the world.

Float down the Cultural Cap Rouge. Celebrate along the Saint Charles. Get productive on the Beauport. Tame Montmorency the Wild.

*Enjoy the Water City & Parc des Quatre Rivières!*

Credits: The WHITE Arkitekter team, Oslo, Norway - Jenny Mäki, Architect (Sweden) Eric Reid, Landscape Architect (Canada), Rebekah Schaberg, Urban Planner (U.S.), Anna Graf, Environmental Design Specialist (Sweden), Joan Rasmussen, Architect (Denmark), Sander Schuur, Sustainable Water Management (Netherlands) and Niels de Bruin, Landscape Architect (Sweden)