

Traditional cultural and sports buildings often make buildings more like urban sculptures because of their single function and emphasis on landmarks, resulting in low efficiency of site space.

With the design of distinctive architecture and space, a variety of use spaces and functions are implanted, so that the entire site can be fully utilized and become a new urban landmark in Sanya.

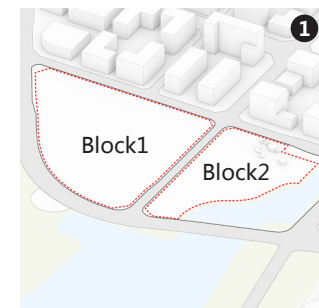

The site consists of 2 blocks with a municipal road passing through the middle. The southwest side is the coast and the northeast side is the urban interface.

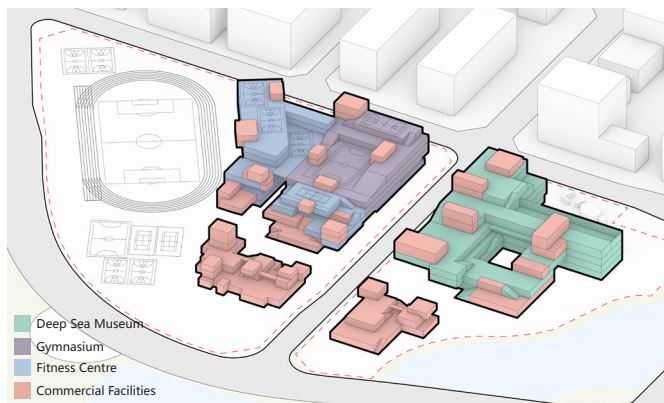
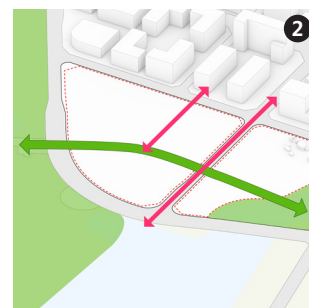

The site is divided into 5 parts by 'the Green Walk' and city roads and new circulation lines.

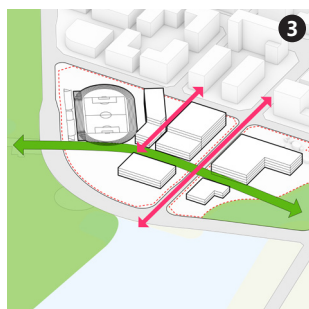

Main functional blocks are situated within the 5 parts. The sports field is arranged at the north corner to make use of the leftover space.

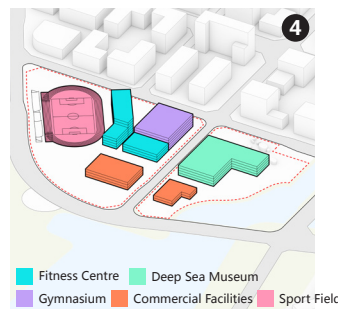

The fitness centre and the commercial facilities are relatively open and are placed on the west and south sides with better orientation and views. The gymnasium and the museum are relatively closed and are placed facing city interface.

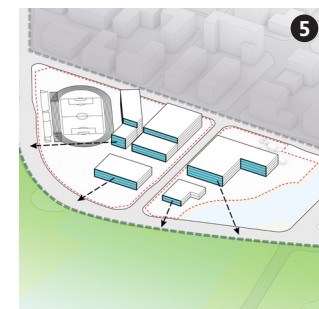

Higher buildings are placed facing the city interface and lower buildings are placed facing the coast to reduce the obstruction of views and maximize the use of landscape resources.



The building block is refined to form a rich and varied terrace roof, and the terrace roof is used as a sports field and roof garden to create an open and three-dimensional urban public space.

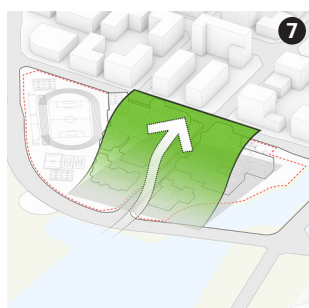

On top of the building mass, a large roof is created to connect to the park, attracting the flow of people from the park to the created three-dimensional garden, and at the same time forming a good shading space under the roof.



The large roof volume is broken into small parts and the corners are tilted so that the natural wind can enter the public space created by the roof of the terrace building, and at the same time, the tilted roof opens up the sea view for the lower buildings.



Sports and leisure commercial functions are placed in the roof garden to create a rich and interesting multi-functional three-dimensional garden for the public.



The meandering roof garden circulation enhances the experience of garden walking. At the same time, the highest part is connected by bridges over the street to eliminate the circulation barrier of the city road.