

The roof of the setback building is integrated with rich cultural and sports activities, which can be accessed from all directions of the site.

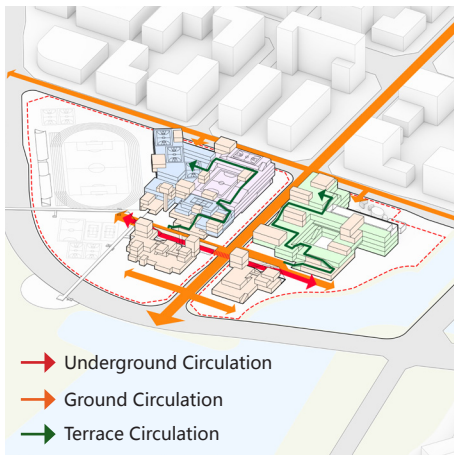

The public can access the building through different circulation lines. The underground circulation through the Green Walk connects the two blocks. There are multiple ground circulation that connect the buildings. The platform building enable the circulation to go upwards.



The landscape of the surrounding wetland park extends to the roof garden ,providing a multidimensional green garden.



Considering the tropical climate of Sanya, the roof terraces not only provide places for public activities. but also provide shades for lower space.

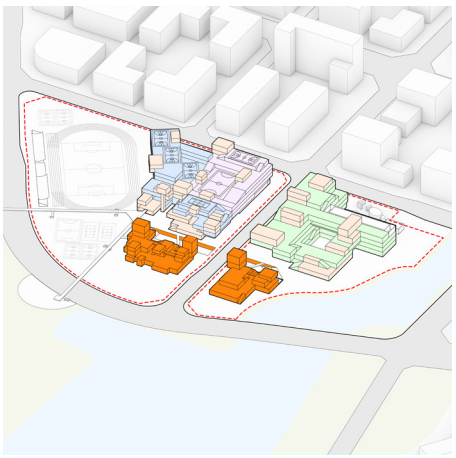

It provides coastal business with the best views of the sea.



The roof garden has multiple passages to the underground building ,and multiple access to the space under the eave.



The roof circulation allows the public to walk and experience the three-dimensional open park which connects two blocks.

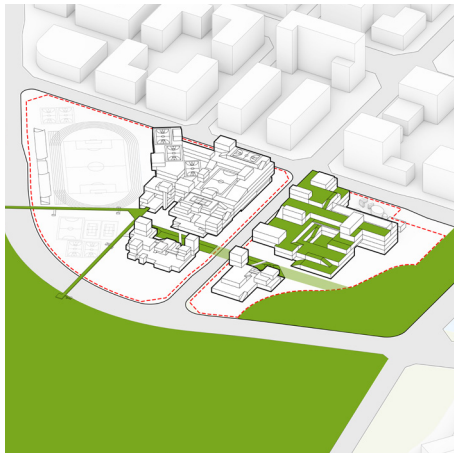

The Leasure Axis and the Bridge connect the adjacent park forming a ecology landscape loop while the riverfront landscape extends to the museum inner courtyard going up to the roof platform.

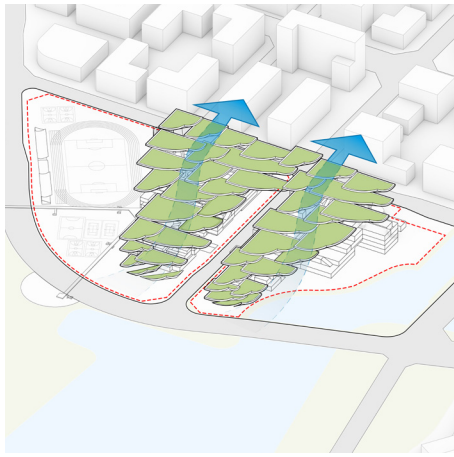

The corners of the unit rooftop garden are warped to provide a smooth path for the sea breeze to enter the overall mitigation of the building.

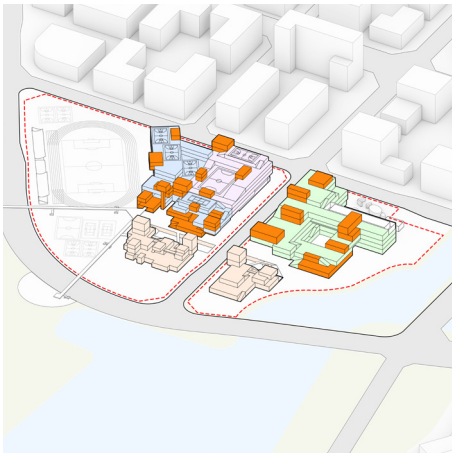

The roofs of the setback buildings are scattered and interspersed with commercial volumes, attracting people to climb and provide a casual sports atmosphere for the roof sports venue.

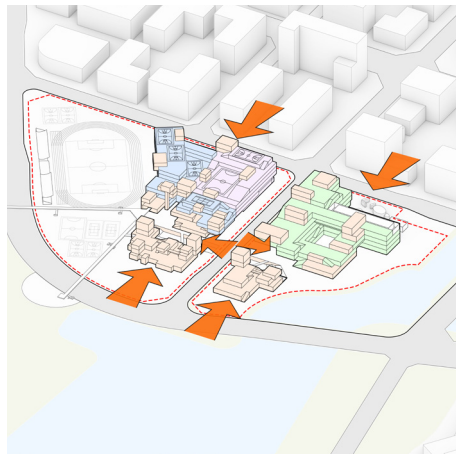

The ground floor plan adopts open and decentralized layout, which is friendly and open to the urban interface.

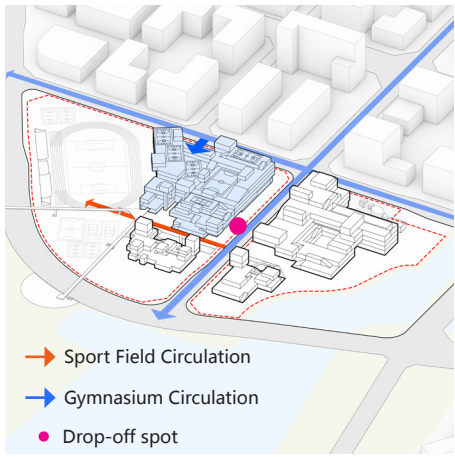

Sports Field Circulation: The public can access the sports field from the drop-off spot and through the Green Walk. The gymnasium can be accessed from the north-west plaza entrance.

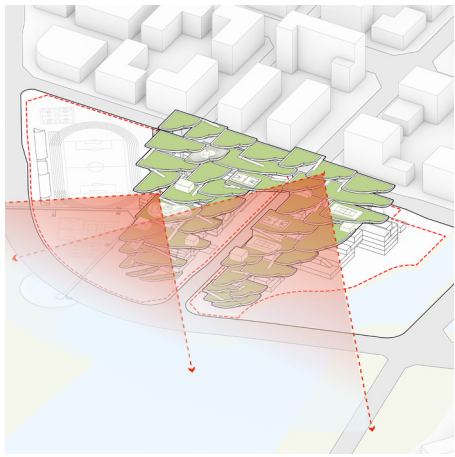

The openings of the set-back building and the roof garden provide fabulous sea views for the lower building.



The roof rainwater harvesting system can recycle rainwater and save water resources.



The commercial volume is interspersed with the roof garden, bringing people to the garden and providing a leisure and comfortable garden business.

## Openess to the Public

## Reasonable and Efficient Circulation

## Maximizing Landscape Resources

## Passive Ecosystems

## Destination-based Vibrant Commerce